

Speed Post

Phone No:- 0381-2326033  
 Fax:- 0381-2323980  
 e-mail:- dswe\_agt@yahoo.com

**GOVERNMENT OF TRIPURA**  
**DIRECTORATE OF SOCIAL WELFARE & SOCIAL EDUCATION**  
**ABHOYNAGAR, AGARTALA, TRIPURA - 799005**

F.2(112)-SW/DC/2010(Vol-III)/PART/1442(3) Dated, Agartala, the 10/07/2020.

To  
 ✓ The Joint Secretary,  
 Government of India,  
 Department of Empowerment of Persons with Disabilities,  
 Ministry of Social Justice & Empowerment,  
 5<sup>th</sup> Floor, Pt. Deendayal Antodaya Bhawan, CGO Complex,  
 Lodhi Road, New Delhi - 110003 (India).

Subject:- **Proposal for release of fund for construction of Barrier Free Environment for Persons with Disabilities under SIPDA scheme.**

Madam,

With reference to the subject cited above, please find enclosed preliminary cost estimate of building prepared by Public Works Department (Buildings), Government of Tripura, as per details shown below with a request for release of requisite fund under SIPDA scheme.

| Sl. No. | Name of Project                                 | Project Cost (in Rupess) |
|---------|---|--------------------------|
| 1.      | Belonia Court Building, Belonia, South Tripura. | 1,50,51,080/-            |

Encls: As stated.

Yours faithfully,

  
 Director  
 Social Welfare & Social Education  
 Tripura

Copy to:

1. P.A. to the Special Secretary, Social Welfare and Social Education, Government of Tripura for kind information of the Special Secretary.
2. The Chief Engineer, (WD) (Buildings), Government of Tripura, Agartala, West Tripura for kind information.

Dh No. 3211/CB  
 29/07/2020



Government of Tripura

**PRELIMINARY COST ESTIMATE**

Proposed construction for creation of **barrier free environment** for the benefit of persons with Disabilities under the **Accessible India Campaign(AIC)** in different State Government buildings of Tripura /**Proposed Remodel/Reorientation of rooms of existing Belonia Court Building, Belonia, South Tripura.**

**Estimated Cost:- ₹ 1,50,51,080.00**

**No: CE(Buildings)/PWD/ ACE(Project Unit)/ Prely(Est)/05/2020-21**

**PUBLIC WORKS DEPARTMENT**



GOVERNMENT OF TRIPURA  
PUBLIC WORKS DEPARTMENT  
AGARTALA, TRIPURA.

State : Tripura

Branch: PWD(Buildings)

**Name of the work:-** Proposed construction for creation of **barrier free environment** for the benefit of persons with Disabilities under the **Accessible India Campaign(AIC)** in different State Government buildings of Tripura / **Proposed Remodel/Reorientation of rooms of existing Belonia Court Building, Belonia, South Tripura.**

Major Head :

Minor Head :

Detailed Head :

The **preliminary Cost estimate** has been framed in the office of the Additional Chief Engineer, Project Unit, PWD(Buildings), Agartala, Tripura, for the probable cost of **Rs. 1,50,51,080.00** [Rupees one crore fifty lakh fifty one thousand eighty ] only including @3% contingencies to meet up the probable cost of providing universal accessibility for persons with Disabilities of the above mentioned building.

## Report

The Department of Empowerment of Persons with Disability (DEPWD), Ministry of Social Justice & Empowerment, Govt of India, had launched the Accessible India Campaign (**Sugamya Bharat Abhiyan**) as a nation-wide flagship campaign for achieving universal accessibility for persons with Disabilities. Many Govt. buildings of Tripura have been selected for making barrier free environment for persons with Disability. The above mentioned work is one of them. The building is **two storied**.

Now Based on the Architectural drawing vide drawing no 9/961, sheet No 1/2 & 2/2 dated 11.03.2020 detailed preliminary cost estimate has been prepared in this office for an amount of **Rs. 1,50,51,080.00** [Rupees one crore fifty lakh fifty one thousand eighty ] only including @3% contingencies to meet up the probable cost for providing universal accessibility for persons with Disabilities of the above mentioned work and also to obtain **Administrative Approval and Expenditure Sanction** of the competent authority.

Contd.P/2

Page-2

**Design and scope****This estimate envisages for the following provisions:-**

- ❖ Construction of parking bay of size 6.00 x 8.00 Sqm with proper signage.
- ❖ An accessible pathway of width 1800mm with chequered tactiles and tactile guiding.
- ❖ Entrance Ramp.
- ❖ Handrails on both sides of stair.
- ❖ Handrails on both sides of corridor with tactile guiding.
- ❖ 13 passenger lift for vertical movement.
- ❖ unisex toilet in every floor of size 1800mm x 2500mm with all facilities for disable persons.

**Salient features about the project:-**

Method : By contract after call of tenders.

Cost : Rs. 1,50,51,080.00 [Rupees one crore fifty lakh fifty one thousand eighty ] only

Rate : Based on Tripura PWD SOR- 2020 and market rate

Time : 06 (six) months.

T & P : No special T & P will be required. Ordinary T & P will be arranged by the agency.

W.C Estt. : Will be met out of the Contingencies.

Land : To be made available.

Specification : As per CPWD specification.

  
61/06/2020  
Junior Engineer  
Project Unit, PWD(B),  
Tripura.

  
02/06/2020  
Assistant Engineer  
Project Unit, PWD(B),  
Tripura.

  
01-06-2020  
Executive Engineer  
Project Unit, PWD(B),  
Tripura.



Proposed construction for creation of barrier free environment for the benefit of persons with Disabilities under the **Accessible India Campaign(AIC)** in different State Government buildings of Tripura /**Proposed Remodel/Reorientation of rooms of existing Belonia Court Building, Belonia, South Tripura.**

**ABSTRACT OF COST**

| SL. No.   | ITEMS OF WORKS  | AMOUNT               |
|---|---|----------------------|
| <b>1</b>  | <b>BUILDING WORKS : ( SoR' 2020 &amp; Market Rate )</b> |                      |
| A   | PARKING   | ₹ 720954.00          |
| B   | ALIGHTING   | ₹ 78409.00           |
| C   | ACCESSIBLE ROUTE  | ₹ 3740285.00         |
| D   | ACCESSIBLE ENTRANCE RAMP                                | ₹ 242031.00          |
| E   | STEPS/STAIRS  | ₹ 774996.00          |
| F   | LIFTS   | ₹ 3061354.00         |
| G   | DOORS AND DOORWAYS                                      | ₹ 320348.00          |
| H   | ACCESSIBLE TOILETS                                      | ₹ 2076930.00         |
| I   | DRINKING WATER  | ₹ 46140.00           |
| J   | CONTROL AND OPERATING MECHANISM                         | ₹ 3296815.00         |
| K   | SIGNAGE   | ₹ 177825.00          |
| L   | EMERGENCY EVACUATION                                    | ₹ 76606.00           |
|   | <b>TOTAL (I)</b>  | ₹ <b>14612693.00</b> |
|   | Add. Contingencies @3% on (I)                           | ₹ 438381.00          |
|   | <b>TOTAL</b>  | ₹ <b>15051074.00</b> |
|   | <b>Say</b>  | ₹ <b>15051080.00</b> |
| <b>( Rupees One Crore Fifty Lakh Fifty One Thousand Eighty ) Only</b> |   |                      |

  
**Junior Engineer**  
 Project Unit, PWD(Bldgs)  
 Agartala, Tripura (W)

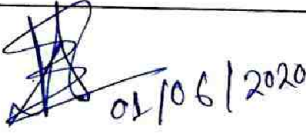
  
**Assistant Engineer**  
 Project Unit, PWD(Bldgs)  
 Agartala, Tripura (W)

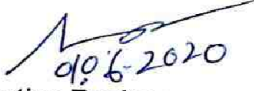
  
**Executive Engineer**  
 Project Unit, PWD(Bldgs)  
 Agartala, Tripura (W)

  
**Superintending Engineer**  
 Project Unit, PWD(Bldgs)  
 Agartala, Tripura (W)

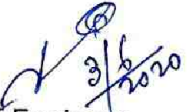
  
**Addl. Chief Engineer**  
 Project Unit, PWD(Bldgs)  
 Agartala, Tripura (W)

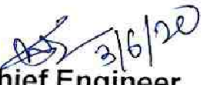
  
**Chief Engineer**  
 Public Works Deptt. (Buildings)  
 Tripura, Agartala.



Proposed construction for creation of barrier free environment for the benefit of persons with Disabilities under the Accessible India Campaign(AIC) in different State Government buildings of Tripura /Proposed Remodel/Reorientation of rooms of existing Belonia Court Building, Belonia, South Tripura.

| SL. NO.                 | PARTICULARS OF ITEMS   | QUANTITY | RATE | UNIT     | AMOUNT   |
|-------------------------|--|----------|------|----------|--|
| <b>BUILDING PORTION</b> |  |          |      |          |  |
| <b>A</b>                | <b>SUB-HEAD : PARKING</b>  |          |      |          |  |
| 1                       | Earth work in excavation by mechanical means (Hydraulic excavator) / manual means in foundation trenches or drains (not exceeding 1.5 m in width or 10 sqm on plan) including dressing of sides and ramming of bottoms, lift upto 1.5 m, including getting out the excavated soil and disposal of surplus excavated soil as directed, within a lead of 50 m. |          |      |          |  |
|                         | All kinds of soil  | 13.824   | Cum  | ₹ 169.50 | Cum  |
|                         |  |          |      |          | ₹ 2343.00  |
|                         |  |          |      |          | ( Rupees One Hundred Sixty Nine & Paise Fifty ) Only     |
| 2                       | Filling available excavated earth (excluding rock) in trenches, plinth, sides of foundations etc. in layers not exceeding 20cm in depth, consolidating each deposited layer by ramming and watering, lead up to 50 m and lift upto 1.5 m.  |          |      |          |  |
|                         | All kinds of soil  | 9.220    | Cum  | ₹ 120.30 | Cum  |
|                         |  |          |      |          | ₹ 1109.00  |
|                         |  |          |      |          | ( Rupees One Hundred Twenty & Paise Thirty ) Only        |
| 3                       | Supplying and filling in plinth, under floor, foundations etc. with sand (fine) from local quarry with all lifts including spreading in horizontal layers, watering, grading to required slope, ramming, consolidating and compacting each layer by using plate compactor or by any suitable method complete.  |          |      |          |  |
|                         |  | 8.060    | Cum  | ₹ 887.50 | Cum  |
|                         |  |          |      |          | ₹ 7153.00  |
|                         |  |          |      |          | ( Rupees Eight Hundred Eighty Seven & Paise Fifty ) Only |
| 4                       | Steel work in built up tubular (round, square or rectangular hollow tubes etc.) trusses etc., including cutting, hoisting, fixing in position and applying a priming coat of approved steel primer, including welding and bolted with special shaped washers etc. complete.  |          |      |          |  |
|                         | (i) Hot finished welded type tubes   | 1340.000 | Kg.  | ₹ 122.90 | Kg.  |
|                         |  |          |      |          | ₹ 164686.00  |
|                         |  |          |      |          | ( Rupees One Hundred Twenty Two & Paise Ninety ) Only    |

| SL. NO. | PARTICULARS OF ITEMS  | QUANTITY |     | RATE   | UNIT | AMOUNT     |
|---------|---|----------|-----|--|------|------------|
| 5       | Supply & installation of pre-painted Galvalume sheets for roofing/cladding (size, shape and pitch of corrugation as approved by Engineer-in-charge) in 550mpa steel grade, made out of Cold Rolled Steel coated with Zinc-Aluminium alloy coating of 43.5% Zn, 55% Al and 1.5% Silicon confirming to ASTM A792/A792M and AS1397, Alloy coating AZ150/AZ70, colour coated with high quality Polyester coating, top coated of modified polyester of 20 micron, back side coat of 5 micron, having epoxy primer coat of 5 micron on both side. Sheet should have protective guard film of 25 microns minimum to avoid scratches while transportation and should be supplied in single length upto 12 metre or as desired by Engineer-in- charge. The sheet shall be fixed using self drilling /self tapping screws of size (5.5x 55mm) with EPDM washers filled with white lead complete upto any pitch in horizontal/ vertical or curved surfaces excluding the cost of purlins, rafters and trusses and including cutting to size and shape wherever required. |          |     |  |      |            |
|         | i) 0.45mm thickness   | 69.300   | Sqm | ₹ 746.10   | Sqm  | ₹ 51705.00 |
|         |   |          |     | ( Rupees Seven Hundred Forty Six & Paise Ten) Only                     |      |            |
| 6       | Supply & installation of pre-painted Galvalume sheets roofing accessories in 550mpa steel steel grade, made out of Cold rolled steel coated with Zinc-Aluminium alloy coating of 43.5% Zn, 55% Al and 1.5% Silicon confirming to AASTM A792/A792M and AS1397, Alloy coating AZ150/AZ70, colour coated with high quality polyester coating, top coated of modified polyester of 20 micron, back side coat of 5 micron, having epoxy primer coat of 5 micron on both side. Sheet should have protective guard film of 25 microns minimum to avoid scratches while transportation. Sheet should have protective guard film of 25 microns minimum to avoid scratches while transportation. The sheet shall be fixed using self drilling /self tapping screws with EPDM washers complete for Ridges/Valley/Gutter/Flashing of width 610mm:   |          |     |  |      |            |
|         | i) 0.45mm thickness   | 9.000    | Mtr | ₹ 412.50   | Mtr. | ₹ 3713.00  |
|         |   |          |     | ( Rupees Four Hundred Twelve & Paise Fifty ) Only                      |      |            |
| 7       | Providing and laying in position cement concrete of specified grade excluding the cost of centring and shuttering -   |          |     |  |      |            |
|         | -All work upto plinth level:  |          |     |  |      |            |
| (a)     | 1:4:8 ( 1 Cement: 4 fine sand : 8 graded stone aggregate 40 mm nominal size)  | 10.020   | Cum | ₹ 9324.50  | Cum  | ₹ 93431.00 |
|         |   |          |     | ( Rupees Nine Thousand Three Hundred Twenty Four & Paise Fifty ) Only. |      |            |
| 8       | Centering shuttering including struttings, propping etc. and removal of form work for:  |          |     |  |      |            |
|         | Foundations, footings, bases for columns.   | 3.840    | sqm | ₹ 238.60   | sqm  | ₹ 916.00   |
|         |   |          |     | ( Rupees Two Hundred Thirty Eight & Paise Sixty ) Only                 |      |            |



53430/2020-SIPDA

| SL. NO. | PARTICULARS OF ITEMS  | QUANTITY |      | RATE  | UNIT | AMOUNT     |
|---------|---|----------|------|---|------|------------|
| 9       | Making plinth protection 50mm thick of cement concrete 1:3:6 (1 cement : 3 fine sand : 6 graded well burnt brick aggregate 20 mm nominal size) over 75mm bed of dry brick ballast 40mm nominal size well rammed and consolidated and grouted with fine sand including finishing the top smooth. | 30.000   | Sqm  | ₹ 810.50  | Sqm  | ₹ 24315.00 |
|         |   |          |      | ( Rupees Eight Hundred Ten & Paise Fifty ) Only                         |      |            |
| 10      | Providing and laying in position specified grade of reinforced cement concrete excluding the cost of centring, shuttering, finishing and reinforcement-<br>-All work upto plinth level:   |          |      |   |      |            |
|         | 1:1½:3 ( 1 Cement: 1½ fine sand : 3 graded stone aggregate 20 mm nominal size)  | 8.268    | Cum  | ₹ 10974.60  | Cum  | ₹ 90738.00 |
|         |   |          |      | ( Rupees Ten Thousand Nine Hundred Seventy Four & Paise Sixty ) Only    |      |            |
| 11      | Reinforced cement concrete work in walls (any thickness), including attached pilasters, buttresses, plinth and skirting courses, fillets, columns, pillars, piers, abutments, posts and struts etc. upto floor five level excluding cost of centring, shuttering, finishing and reinforcement-  |          |      |   |      |            |
|         | 1:1½:3 ( 1 Cement: 1½ fine sand : 3 graded stone aggregate 20 mm nominal size)  | 2.160    | Cum  | ₹ 11791.90  | Cum  | ₹ 25471.00 |
|         |   |          |      | ( Rupees Eleven Thousand Seven Hundred Ninety One & Paise Ninety ) Only |      |            |
| 12      | Reinforcement for R.C.C. work including straightening, cutting, bending, placing in position and binding all complete upto plinth level.  |          |      |   |      |            |
|         | Thermo-Mechanically Treated bars of grade Fe-500D or more   | 1130.160 | Kg.  | ₹ 78.20   | Kg.  | ₹ 88379.00 |
|         |   |          |      | ( Rupees Seventy Eight & Paise Twenty ) Only                            |      |            |
| 13      | Reinforcement for R.C.C. work including straightening, cutting, bending, placing in position and binding all complete above plinth level.   |          |      |   |      | ₹ 0.00     |
|         | Thermo-Mechanically Treated bars of grade Fe-500D or more   | 324.000  | Kg.  | ₹ 78.20   | Kg.  | ₹ 25337.00 |
|         |   |          |      | ( Rupees Seventy Eight & Paise Twenty ) Only                            |      |            |
| 14      | Centering shuttering including struttings, propping etc. and removal of form work for:  |          |      |   |      |            |
| (a)     | Foundations, footings, bases for columns etc. for mass concrete with timber plank   | 13.440   | Sqm. | ₹ 268.90  | Sqm  | ₹ 3614.00  |
|         |   |          |      | ( Rupees Two Hundred Sixty Eight & Paise Ninety ) Only                  |      |            |
| (b)     | Lintels, beams, plinth beams, girders, bressumers and cantilevers with shuttering ply   | 19.600   | Sqm. | ₹ 385.20  | Sqm  | ₹ 7550.00  |



| SL. NO.  | PARTICULARS OF ITEMS   | QUANTITY | RATE  | UNIT         | AMOUNT             |
|----------|--|----------|---|--------------|--------------------|
|          |  |          | ( Rupees Three Hundred Eighty Five & Paise Twenty ) Only                |              |                    |
| (c)      | Columns, Pillars, Piers, Abutments, Posts and Struts with shuttering ply   | 46.080   | Sqm.  | ₹ 483.00     | Sqm ₹ 22257.00     |
|          |  |          | ( Rupees Four Hundred Eighty Three ) Only                               |              |                    |
| 15       | First class brick work in foundation and plinth including cost of all materials as required complete:-   |          |   |              |                    |
| (a)      | In cement mortar 1:4 ( 1 cement : 4 fine sand ).   | 2.175    | Cum   | ₹ 8888.40    | Cum ₹ 19332.00     |
|          |  |          | ( Rupees Eight Thousand Eight Hundred Eighty Eight & Paise Forty ) Only |              |                    |
| (b)      | In cement mortar 1:6 ( 1 cement : 6 fine sand ).   | 6.525    | Cum   | ₹ 8624.10    | Cum ₹ 56272.00     |
|          |  |          | ( Rupees Eight Thousand Six Hundred Twenty Four & Paise Ten ) Only      |              |                    |
| 16       | Providing and fixing precast chequered cement concrete tiles 18 mm thick, laid in footpath & courtyard, on 20 mm thick bed of cement mortar 1 : 4 ( 1 cement : 4 fine sand ) jointed with neat cement slurry including rubbing and cleaning complete as per direction of the Engineer-in-Charge.   | 48.000   | Sqm   | ₹ 573.60     | Sqm ₹ 27533.00     |
|          |  |          | ( Rupees Five Hundred Seventy Three & Paise Sixty ) Only                |              |                    |
| 17       | Painting with synthetic enamel paint of approved brand and manufacture to give an even shade [Payment shall be made after submission of Test Certificate issued by the Manufacturer]:  |          |   |              |                    |
|          | Two or more coats on new work  | 61.600   | Sqm.  | ₹ 82.80      | Sqm. ₹ 5100.00     |
|          |  |          | ( Rupees Eighty Two & Paise Eighty ) Only                               |              |                    |
|          |  |          |   | <b>TOTAL</b> | <b>₹ 720954.00</b> |
| <b>B</b> | <b>SUB-HEAD : ALIGHTING WORK</b>   |          |   |              |                    |
| 18       | Providing and fixing precast chequered cement concrete tiles 18 mm thick, laid in footpath & courtyard, on 20 mm thick bed of cement mortar 1 : 4 ( 1 cement : 4 fine sand ) jointed with neat cement slurry including rubbing and cleaning complete as per direction of the Engineer-in-Charge.   | 63.945   | Sqm   | ₹ 573.60     | Sqm ₹ 36679.00     |
|          |  |          | ( Rupees Five Hundred Seventy Three & Paise Sixty ) Only                |              |                    |
| 19       | Providing and fixing tactiles of standardized designs conforming to RNIB (The Royal National Institute for the Blind, UK), DETR (Department of the Environment, Transport and the Regions, UK) & ADA (Americans with Disabilities Act, USA) of size 300 x 300 mm in floors, (thickness to be specified by the manufacturer) specially designed to assist the visually impaired - "foot braille", with water absorption less than 0.5%, of approved brand & manufacturer, laid on 20 mm thick bed of cement mortar 1 : 4 ( 1 cement : 4 fine sand ) including grouting of joints (Payment for grouting of joints to be made separately) | 12.256   | Sqm   | ₹ 3404.80    | Sqm ₹ 41730.00     |

| SL. NO. | PARTICULARS OF ITEMS   | QUANTITY | RATE  | UNIT  | AMOUNT            |
|---------|--|----------|---|---|-------------------|
|         |  |          | ( Rupees Three Thousand Four Hundred Four & Paise Eighty ) Only |   |                   |
| C       | <b>SUB-HEAD : ACCESSIBLE ROUTE</b>   |          |   | <b>TOTAL</b>  | <b>₹ 78409.00</b> |
| 20      | Earth work in excavation by mechanical means (Hydraulic excavator) / manual means in foundation trenches or drains (not exceeding 1.5 m in width or 10 sqm on plan) including dressing of sides and ramming of bottoms, lift upto 1.5 m, including getting out the excavated soil and disposal of surplus excavated soil as directed, within a lead of 50 m. | 20.250   | cum   | ₹ 169.50  | cum ₹ 3432.00     |
|         |  |          |   | ( Rupees One Hundred Sixty Nine & Paise Fifty ) Only                  |                   |
| 21      | Filling available excavated earth (excluding rock) in trenches, plinth, sides of foundations etc. in layers not exceeding 20cm in depth, consolidating each deposited layer by ramming and watering, lead up to 50 m and lift upto 1.5 m.  | 13.500   | Cum   | ₹ 120.30  | cum ₹ 1624.00     |
|         |  |          |   | ( Rupees One Hundred Twenty & Paise Thirty ) Only                     |                   |
| 22      | Supplying and filling in plinth, under floor, foundations etc. with sand (fine) from local quarry with all lifts including spreading in horizontal layers, watering, grading to required slope, ramming, consolidating and compacting each layer by using plate compactor or by any suitable method complete.  | 1.350    | Cum   | ₹ 887.50  | Cum ₹ 1198.00     |
|         |  |          |   | ( Rupees Eight Hundred Eighty Seven & Paise Fifty ) Only              |                   |
| 23      | Providing and laying in position cement concrete of specified grade excluding the cost of centring and shuttering -  |          |   |   |                   |
|         | 1:4:8 ( 1 Cement: 4 fine sand : 8 graded stone aggregate 40 mm nominal size)   | 8.910    | Cum   | ₹ 9324.50   | Cum ₹ 83081.00    |
|         |  |          |   | ( Rupees Nine Thousand Three Hundred Twenty Four & Paise Fifty ) Only |                   |
| 24      | Centering shuttering including struttings, propping etc. and removal of form work for:   |          |   |   |                   |
|         | Foundations, footings, bases for columns.  | 3.600    | Sqm   | ₹ 238.60  | Sqm ₹ 859.00      |
|         |  |          |   | ( Rupees Two Hundred Thirty Eight & Paise Sixty ) Only                |                   |
| 25      | Providing and laying in position specified grade of reinforced cement concrete excluding the cost of centring, shuttering, finishing and reinforcement-<br>-All work upto plinth level:<br>1:1½:3 ( 1 Cement: 1½ fine sand : 3 graded stone aggregate 20 mm nominal size)  | 7.445    | Cum   | ₹ 10974.60  | Cum ₹ 81709.00    |



53430/2020/SIPDA

| NO. | PARTICULARS OF ITEMS   | QUANTITY | RATE  | UNIT       | AMOUNT          |
|-----|--|----------|---|------------|-----------------|
|     |  |          | ( Rupees Ten Thousand Nine Hundred Seventy Four & Paise Sixty ) Only    |            |                 |
| 26  | Reinforced cement concrete work in walls (any thickness), including attached pilasters, buttresses, plinth and skirting courses, fillets, columns, pillars, piers, abutments, posts and struts etc. upto floor five level excluding cost of centring, shuttering, finishing and reinforcement--<br>1:1½:3 ( 1 Cement: 1½ fine sand : 3 graded stone aggregate 20 mm nominal size)      |          |   |            |                 |
|     |  | 6.804    | Cum   | ₹ 11791.90 | Cum ₹ 80232.00  |
|     |  |          | ( Rupees Eleven Thousand Seven Hundred Ninety One & Paise Ninety ) Only |            |                 |
| 27  | Reinforced cement concrete work in beams, suspended floors, roofs having slope upto 15° landings, balconies, shelves, chajjas, lintels, bands, plain window sills, staircases and spiral stair cases upto floor five level excluding the cost of centring, shuttering, finishing and reinforcement--<br>1:1½:3 ( 1 Cement: 1½ fine sand : 3 graded stone aggregate 20 mm nominal size) |          |   |            |                 |
|     |  | 19.710   | Sqm   | ₹ 12104.70 | Sqm ₹ 238584.00 |
|     |  |          | ( Rupees Twelve Thousand One Hundred Four & Paise Seventy ) Only        |            |                 |
| 28  | Reinforcement for R.C.C. work including straightening, cutting, bending, placing in position and binding all complete upto plinth level.   |          |   |            |                 |
|     | Thermo-Mechanically Treated bars of grade Fe-500D or more  | 1340.145 | kg  | ₹ 78.20    | kg ₹ 104799.00  |
|     |  |          | ( Rupees Seventy Eight & Paise Twenty ) Only                            |            |                 |
| 29  | Reinforcement for R.C.C. work including straightening, cutting, bending, placing in position and binding all complete above plinth level.  |          |   |            |                 |
|     | Thermo-Mechanically Treated bars of grade Fe-500D or more  | 4772.520 | kg  | ₹ 78.20    | kg ₹ 373211.00  |
|     |  |          | ( Rupees Seventy Eight & Paise Twenty ) Only                            |            |                 |
| 30  | Centering shuttering including struttings, propping etc. and removal of form work for:   |          |   |            |                 |
| a   | Foundations, footings, bases for columns etc. for mass concrete with timber plank  | 2.880    | Sqm   | ₹ 268.90   | Sqm ₹ 774.00    |
|     |  |          | ( Rupees Two Hundred Sixty Eight & Paise Ninety ) Only                  |            |                 |



53430/2020/SIPDA

| SL. NO. | PARTICULARS OF ITEMS   | QUANTITY |     | RATE   | UNIT | AMOUNT     |
|---------|--|----------|-----|--|------|------------|
| b       | Suspended floors, roofs, landings, balconies and access platform with 12 mm thick shuttering ply   | 81.000   | Sqm | ₹ 539.00   | Sqm  | ₹ 43659.00 |
|         |  |          |     | ( Rupees Five Hundred Thirty Nine ) Only                           |      |            |
| c       | Lintels, beams, plinth beams, girders, bressumers and cantilevers with shuttering ply  | 50.400   | Sqm | ₹ 385.20   | Sqm  | ₹ 19414.00 |
|         |  |          |     | ( Rupees Three Hundred Eighty Five & Paise Twenty ) Only           |      |            |
| d       | Columns, Pillars, Piers, Abutments, Posts and Struts with wooden plank   | 69.120   | Sqm | ₹ 462.30   | Sqm  | ₹ 31954.00 |
|         |  |          |     | ( Rupees Four Hundred Sixty Two & Paise Thirty ) Only              |      |            |
| 31      | Half brick masonry work with first class bricks in superstructure upto floor five level including cost of all materials as required complete:-   |          |     |  |      |            |
|         | In cement mortar 1:4 ( 1 cement : 4 fine sand ).   | 24.300   | Sqm | ₹ 1363.10  | Sqm  | ₹ 33123.00 |
|         |  |          |     | ( Rupees One Thousand Three Hundred Sixty Three & Paise Ten ) Only |      |            |
| 32      | 12 mm cement plaster of mix  |          |     |  |      |            |
|         | In cement mortar 1 : 6 ( 1 cement : 6 fine sand )  | 48.600   | Sqm | ₹ 159.60   | Sqm  | ₹ 7757.00  |
|         |  |          |     | ( Rupees One Hundred Fifty Nine & Paise Sixty ) Only               |      |            |
| 33      | 6 mm cement plaster of mix:  |          |     |  |      |            |
|         | In cement mortar 1 : 3 ( 1 cement : 3 fine sand )  | 150.120  | Sqm | ₹ 144.50   | Sqm  | ₹ 21692.00 |
|         |  |          |     | ( Rupees One Hundred Forty Four & Paise Fifty ) Only               |      |            |
| 34      | Distempering with oil bound washable distemper of approved brand and manufacture and of required shade on new work ( two or more coats ), over and including water thinnable priming coat to give an even shade. [Payment shall be made after submission of Test Certificate issued by the Manufacturer] |          |     |  |      |            |
|         |  | 105.300  | Sqm | ₹ 95.70  | Sqm  | ₹ 10077.00 |
|         |  |          |     | ( Rupees Ninety Five & Paise Seventy ) Only                        |      |            |
| 35      | Finishing walls with premium acrylic smooth exterior paint with Silicon additives of required shade of approved brand and manufacture [Payment shall be made after submission of Test Certificate issued by the Manufacturer] :  |          |     |  |      |            |
|         | New work ( two or more coats applied @ 1.43 litre/10 sqm over and including priming coat of exterior primer applied @ 2.20 kg/10 sqm )   | 24.300   | Sqm | ₹ 119.30   | Sqm  | ₹ 2899.00  |

| SL. NO. | PARTICULARS OF ITEMS   | QUANTITY |     | RATE  | UNIT         | AMOUNT              |
|---------|--|----------|-----|---|--------------|---------------------|
|         |  |          |     | ( Rupees One Hundred Nineteen & Paise Thirty ) Only             |              |                     |
| 36      | Providing and fixing Marble stone in floors over 20 mm thick bed of cement mortar 1 : 4 ( 1 cement : 4 fine sand ) jointed with ordinary cement slurry including pointing with white cement mixed with of matching shade, including rubbing and polishing complete.<br>18 mm thick Marble stone  |          |     |   |              |                     |
|         | Raj Nagar plain marble   | 40.500   | Sqm | ₹ 1900.10   | Sqm          | ₹ 76954.00          |
|         |  |          |     | ( Rupees One Thousand Nine Hundred & Paise Ten ) Only           |              |                     |
| 37      | Providing and fixing tactile of standardized designs conforming to RNIB (The Royal National Institute for the Blind, UK), DETR (Department of the Environment, Transport and the Regions, UK) & ADA (Americans with Disabilities Act, USA) of size 300 x 300 mm in floors, (thickness to be specified by the manufacturer) specially designed to assist the visually impaired - "foot braille", with water absorption less than 0.5%, of approved brand & manufacturer, laid on 20 mm thick bed of cement mortar 1 : 4 ( 1 cement : 4 fine sand ) including grouting of joints (Payment for grouting of joints to be made separately)  | 88.035   | Sqm | ₹ 3404.80   | Sqm          | ₹ 299742.00         |
|         |  |          |     | ( Rupees Three Thousand Four Hundred Four & Paise Eighty ) Only |              |                     |
| 38      | Providing and fixing stainless steel (Grade 304) railing made of Hollow tubes, channels, plates etc. including welding, grinding, buffing, polishing and making curvature (wherever required) and fitting the same with necessary stainless steel nuts and bolts complete, including fixing the railing with necessary accessories & stainless steel dash fasteners, stainless steel bolts etc., of required size, on the top of the floor or the side of waist slab with suitable arrangement as per approval of Engineer-in-charge, (for payment purpose only weight of stainless steel members shall be considered excluding fixing accessories such as nuts, bolts, fasteners etc.). | 4174.040 | Kg. | ₹ 532.70  | Kg.          | ₹ 2223511.00        |
|         |  |          |     | ( Rupees Five Hundred Thirty Two & Paise Seventy ) Only         |              |                     |
|         |  |          |     |   | <b>TOTAL</b> | <b>₹ 3740285.00</b> |
| D       | <b>SUB-HEAD : ACCESSIBLE ENTRANCE RAMP</b>   |          |     |   |              |                     |



53430/2020/SIPDA

| SL. NO. | PARTICULARS OF ITEMS   | QUANTITY |     | RATE   | UNIT | AMOUNT      |
|---------|--|----------|-----|--|------|-------------|
| 39      | Earth work in excavation by mechanical means (Hydraulic excavator) / manual means in foundation trenches or drains (not exceeding 1.5 m in width or 10 sqm on plan) including dressing of sides and ramming of bottoms, lift upto 1.5 m, including getting out the excavated soil and disposal of surplus excavated soil as directed, within a lead of 50 m.   |          |     |  |      |             |
|         | All kinds of soil  | 39.445   | Cum | ₹ 169.50   | Cum  | ₹ 6686.00   |
|         |  |          |     | ( Rupees One Hundred Sixty Nine &                                  |      |             |
| 40      | Filling available excavated earth (excluding rock) in trenches, plinth, sides of foundations etc. in layers not exceeding 20cm in depth, consolidating each deposited layer by ramming and watering, lead up to 50 m and lift upto 1.5 m.  |          |     |  |      |             |
|         |  | 26.300   | Cum | ₹ 120.30   | Cum  | ₹ 3164.00   |
|         |  |          |     | ( Rupees One Hundred Twenty &                                      |      |             |
| 41      | Supplying and filling in plinth, under floor, foundations etc. with sand (fine) from local quarry with all lifts including spreading in horizontal layers, watering, grading to required slope, ramming, consolidating and compacting each layer by using plate compactor or by any suitable method complete.  | 8.041    | Cum | ₹ 887.50   | Cum  | ₹ 7136.00   |
|         |  |          |     | ( Rupees Eight Hundred Eighty                                      |      |             |
| 42      | Providing and laying in position cement concrete of specified grade excluding the cost of centring and shuttering -  |          |     |  |      |             |
|         | -All work upto plinth level:   |          |     |  |      |             |
| (a)     | 1:4:8 ( 1 Cement: 4 fine sand : 8 graded stone aggregate 40 mm nominal size)   | 5.361    | Cum | ₹ 9324.50  | Cum  | ₹ 49985.00  |
|         |  |          |     | ( Rupees Nine Thousand Three Hundred Twenty Four & Paise Fifty )   |      |             |
|         |  |          |     | Only   |      |             |
| 43      | Providing and laying in position cement concrete of specified grade excluding the cost of centring and shuttering -  |          |     |  |      |             |
|         | -All work upto plinth level:   |          |     |  |      |             |
| (a)     | 1:4:8 ( 1 Cement: 4 fine sand : 8 graded stone aggregate 40 mm nominal size)   | 0.000    | Cum | ₹ 9324.50  | Cum  | ₹ 0.00      |
|         |  |          |     | ( Rupees Nine Thousand Three Hundred Twenty Four & Paise Fifty )   |      |             |
|         |  |          |     | Only   |      |             |
| 43      | First class brick work in foundation and plinth including cost of all materials as required complete:-   |          |     |  |      |             |
| (a)     | In cement mortar 1:4 ( 1 cement : 4 fine sand ).   | 2.496    | Cum | ₹ 8888.40  | Cum  | ₹ 22188.00  |
|         |  |          |     | ( Rupees Eight Thousand Eight Hundred Eighty Eight & Paise Forty ) |      |             |
| 44      | Providing and fixing stainless steel (Grade 304) railing made of Hollow tubes, channels, plates etc., including welding, grinding, buffing, polishing and making curvature (wherever required) and fitting the same with necessary stainless steel nuts and bolts complete, including fixing the railing with necessary accessories & stainless steel dash fasteners , stainless steel bolts etc., of required size, on the top of the floor or the side of waist slab with suitable arrangement as per approval of Engineer-in-charge, (for payment purpose only weight of stainless steel members shall be considered excluding fixing accessories such as | 193.180  | Kg. | ₹ 532.70   | Kg.  | ₹ 102907.00 |



53430/2020/SIPDA

| SL. NO.  | PARTICULARS OF ITEMS   | QUANTITY | RATE  | UNIT  | AMOUNT          |
|----------|--|----------|---|---|-----------------|
|          |  |          | ( Rupees Five Hundred Thirty Two & Paise Seventy ) Only |   |                 |
| 45       | Providing and fixing precast chequered cement concrete tiles 18 mm thick, laid in footpath & courtyard, on 20 mm thick bed of cement mortar 1 : 4 ( 1 cement : 4 fine sand ) jointed with neat cement slurry including rubbing and cleaning complete as per direction of the Engineer-in-Charge.   | 53.606   | Kg.   | ₹ 573.60  | Kg. ₹ 30748.00  |
|          |  |          |   | ( Rupees Five Hundred Seventy Three & Paise Sixty ) Only        |                 |
| 46       | Providing and fixing tactiles of standardized designs conforming to RNIB (The Royal National Institute for the Blind, UK), DETR (Department of the Environment, Transport and the Regions, UK) & ADA (Americans with Disabilities Act, USA) of size 300 x 300 mm in floors, (thickness to be specified by the manufacturer) specially designed to assist the visually impaired - "foot braille", with water absorption less than 0.5%, of approved brand & manufacturer, laid on 20 mm thick bed of cement mortar 1 : 4 ( 1 cement : 4 fine sand ) including grouting of joints (Payment for grouting of joints to be made separately)   | 5.644    | Kg.   | ₹ 3404.80   | Kg. ₹ 19217.00  |
|          |  |          |   | ( Rupees Three Thousand Four Hundred Four & Paise Eighty ) Only |                 |
|          |  |          |   | Total   | ₹ 242031.00     |
| <b>E</b> | <b>SUB-HEAD : STEPS/STAIRS</b>   |          |   |   |                 |
| 47       | Providing and fixing stainless steel (Grade 304) railing made of Hollow tubes, channels, plates etc., including welding, grinding, buffing, polishing and making curvature (wherever required) and fitting the same with necessary stainless steel nuts and bolts complete, including fixing the railing with necessary accessories & stainless steel dash fasteners , stainless steel bolts etc., of required size, on the top of the floor or the side of waist slab with suitable arrangement as per approval of Engineer-in-charge, (for payment purpose only weight of stainless steel members shall be considered excluding fixing accessories such as nuts, bolts, fasteners etc.). | 1134.900 | Kg.   | ₹ 532.70  | Kg. ₹ 604561.00 |
|          |  |          |   | ( Rupees Five Hundred Thirty Two & Paise Seventy ) Only         |                 |
| 48       | Providing Contrast strips for steps 150 cm x 20 cm including fitting, fixing etc   | 242.200  | mtr   | ₹ 535.00  | mtr ₹ 129577.00 |
|          |  |          |   | ( Rupees Five Hundred Thirty Five ) Only                        |                 |

53430/2020/SIPDA

| SL. NO. | PARTICULARS OF ITEMS   | QUANTITY | RATE | UNIT         | AMOUNT  |
|---------|--|----------|------|--------------|---|
| 49      | Providing and fixing tactiles of standardized designs conforming to RNIB (The Royal National Institute for the Blind, UK), DETR (Department of the Environment, Transport and the Regions, UK) & ADA (Americans with Disabilities Act, USA) of size 300 x 300 mm in floors, (thickness to be specified by the manufacturer) specially designed to assist the visually impaired - "foot braille", with water absorption less than 0.5%, of approved brand & manufacturer, laid on 20 mm thick bed of cement mortar 1 : 4 ( 1 cement : 4 fine sand ) including grouting of joints (Payment for grouting of joints to be made separately) | 12.000   | Sqm  | ₹ 3404.80    | Sqm   |
|         |  |          |      |              | ₹ 40858.00  |
|         |  |          |      |              | ( Rupees Three Thousand Four Hundred Four & Paise Eighty ) Only       |
| F       | <b>SUB-HEAD : LIFTS</b>  |          |      | <b>TOTAL</b> | <b>₹ 774996.00</b>  |
| 50      | Earth work in excavation by mechanical means (Hydraulic excavator) / manual means in foundation trenches or drains (not exceeding 1.5 m in width or 10 sqm on plan) including dressing of sides and ramming of bottoms, lift upto 1.5 m, including getting out the excavated soil and disposal of surplus excavated soil as directed, within a lead of 50 m.   |          |      |              |   |
|         | All kinds of soil  | 20.625   | Cum  | ₹ 169.50     | Cum   |
|         |  |          |      |              | ₹ 3496.00   |
|         |  |          |      |              | ( Rupees One Hundred Sixty Nine & Paise Fifty ) Only                  |
| 51      | Filling available excavated earth (excluding rock) in trenches, plinth, sides of foundations etc. in layers not exceeding 20cm in depth, consolidating each deposited layer by ramming and watering, lead up to 50 m and lift upto 1.5 m.  |          |      |              |   |
|         | All kinds of soil  | 13.750   | Cum  | ₹ 120.30     | Cum   |
|         |  |          |      |              | ₹ 1654.00   |
|         |  |          |      |              | ( Rupees One Hundred Twenty & Paise Thirty ) Only                     |
| 52      | Supplying and filling in plinth, under floor, foundations etc. with sand (fine) from local quarry with all lifts including spreading in horizontal layers, watering, grading to required slope, ramming, consolidating and compacting each layer by using plate compactor or by any suitable method complete.  | 1.375    | Cum  | ₹ 887.50     | Cum   |
|         |  |          |      |              | ₹ 1220.00   |
|         |  |          |      |              | ( Rupees Eight Hundred Eighty Seven & Paise Fifty ) Only              |
| 53      | Providing and laying in position cement concrete of specified grade excluding the cost of centring and shuttering -  |          |      |              |   |
|         | 1:4:8 ( 1 Cement: 4 fine sand : 8 graded stone aggregate 40 mm nominal size)   | 1.935    | Cum  | ₹ 9324.50    | Cum   |
|         |  |          |      |              | ₹ 18043.00  |
|         |  |          |      |              | ( Rupees Nine Thousand Three Hundred Twenty Four & Paise Fifty ) Only |
| 54      | Centering shuttering including struttings, propping etc. and removal of form work for:   |          |      |              |   |
|         | Foundations, footings, bases for columns.  |          |      |              |   |
|         | floor  | 2.400    | Cum  | ₹ 238.60     | Cum   |
|         |  |          |      |              | ₹ 573.00  |



| SL. NO. | PARTICULARS OF ITEMS  | QUANTITY |      | RATE  | UNIT | AMOUNT      |
|---------|---|----------|------|---|------|-------------|
|         |   |          |      | ( Rupees Two Hundred Thirty Eight & Paise Sixty ) Only                  |      |             |
| 55      | Providing and laying in position specified grade of reinforced cement concrete excluding the cost of centring, shuttering, finishing and reinforcement-<br>-All work upto plinth level:   |          |      |   |      |             |
|         | 1:1½:3 ( 1 Cement: 1½ fine sand : 3 graded stone aggregate 20 mm nominal size)  | 5.852    | Cum  | ₹ 10974.60  | Cum  | ₹ 64223.00  |
|         |   |          |      | ( Rupees Ten Thousand Nine Hundred Seventy Four & Paise Sixty ) Only    |      |             |
| 56      | Reinforced cement concrete work in <b>walls</b> (any thickness), including attached pilasters, buttresses, plinth and skirting courses, fillets, <b>columns</b> , pillars, piers, abutments, posts and struts etc. upto floor five level excluding cost of centring, shuttering, finishing and reinforcement- |          |      |   |      |             |
|         | 1:1½:3 ( 1 Cement: 1½ fine sand : 3 graded stone aggregate 20 mm nominal size)  | 25.584   | Cum  | ₹ 11791.90  | Cum  | ₹ 301684.00 |
|         |   |          |      | ( Rupees Eleven Thousand Seven Hundred Ninety One & Paise Ninety ) Only |      |             |
| 57      | Reinforced cement concrete work in <b>beams, suspended floors</b> , roofs having slope upto 15° landings, balconies, shelves, chajjas, lintels, bands, plain window sills, staircases and spiral stair cases upto floor five level excluding the cost of centring, shuttering, finishing and reinforcement-   |          |      |   |      |             |
|         | 1:1½:3 ( 1 Cement: 1½ fine sand : 3 graded stone aggregate 20 mm nominal size)  | 7.482    | Cum  | ₹ 12104.70  | Cum  | ₹ 90567.00  |
|         |   |          |      | ( Rupees Twelve Thousand One Hundred Four & Paise Seventy ) Only        |      |             |
| 58      | Reinforcement for R.C.C. work including straightening, cutting, bending, placing in position and binding all complete <b>upto plinth level</b> .  |          |      |   |      |             |
|         | Thermo-Mechanically Treated bars of grade Fe-500D or more   | 1053.360 | Kg.  | ₹ 78.20   | Kg.  | ₹ 82373.00  |
|         | ( Rupees Seventy Eight & Paise Twenty ) Only  |          |      |   |      |             |
| 59      | Reinforcement for R.C.C. work including straightening, cutting, bending, placing in position and binding all complete <b>above plinth level</b> .   |          |      |   |      |             |
|         | Thermo-Mechanically Treated bars of grade Fe-500D or more   | 5951.880 | Kg.  | ₹ 78.20   | Kg.  | ₹ 465437.00 |
|         | ( Rupees Seventy Eight & Paise Twenty ) Only  |          |      |   |      |             |
| 60      | Centering shuttering including struttings, propping etc. and removal of form work for:  |          |      |   |      |             |
| (a)     | Foundations, footings, bases for columns etc. for mass concrete with timber plank   | 5.520    | Sqm. | ₹ 268.90  | Sqm  | ₹ 1484.00   |
|         |   |          |      | ( Rupees Two Hundred Sixty Eight & Paise Ninety ) Only                  |      |             |
| b)      | Suspended floors, roofs, landings, balconies and access platform with 12 mm thick shuttering ply  | 25.200   | Sqm. | ₹ 539.00  | Sqm  | ₹ 13583.00  |



53430/2020-SIPDA

| SL. NO. | PARTICULARS OF ITEMS  | QUANTITY | RATE  | UNIT         | AMOUNT           |
|---------|---|----------|---|--------------|------------------|
|         |   |          | ( Rupees Five Hundred Thirty Nine ) Only                      |              |                  |
| (c)     | Lintels, beams, plinth beams, girders, bressumers and cantilevers with shuttering ply   | 17.000   | Sqm.  | ₹ 385.20     | Sqm ₹ 6548.00    |
|         |   |          | ( Rupees Three Hundred Eighty Five & Paise Twenty ) Only      |              |                  |
| (d)     | Columns, Pillars, Piers, Abutments, Posts and Struts with shuttering ply  | 71.040   | Sqm.  | ₹ 483.00     | Sqm ₹ 34312.00   |
|         |   |          | ( Rupees Four Hundred Eighty Three ) Only                     |              |                  |
| e)      | Walls (any thickness) including attached pilasters, buttresses, plinth and string courses etc. using shuttering ply   | 207.360  | Sqm.  | ₹ 370.00     | Sqm ₹ 76723.00   |
|         |   |          | ( Rupees Three Hundred Seventy )                              |              |                  |
| 61      | Half brick masonry work with first class bricks in superstructure upto floor five level including cost of all materials as required complete:-<br>In cement mortar 1 : 4 ( 1 cement : 4 fine sand )                             | 40.800   | Sqm.  | ₹ 1363.10    | Sqm ₹ 55614.00   |
|         |   |          | ( Rupees One Thousand Three Hundred Sixty Three & Paise Ten ) |              |                  |
| 62      | 12 mm cement plaster of mix<br>In cement mortar 1 : 6 ( 1 cement : 6 fine sand )  | 40.800   | Sqm.  | ₹ 159.60     | Sqm ₹ 6512.00    |
|         |   |          | ( Rupees One Hundred Fifty Nine & Paise Sixty ) Only          |              |                  |
| 63      | 6 mm cement plaster of mix:<br>In cement mortar 1 : 3 ( 1 cement : 3 fine sand )  | 128.880  | Sqm.  | ₹ 144.50     | Sqm ₹ 18623.00   |
|         |   |          | ( Rupees One Hundred Forty Four & Paise Fifty ) Only          |              |                  |
| 64      | Distempering with oil bound washable distemper of approved brand and manufacture to give an even shade [Payment shall be made after submission of Test Certificate issued by the Manufacturer] :                                |          |   |              |                  |
|         | New work ( two or more coats) over and including water thinnable priming coat with cement primer.   | 66.000   | Sqm.  | ₹ 95.70      | Sqm ₹ 6316.00    |
|         |   |          | ( Rupees Ninety Five & Paise Seventy ) Only                   |              |                  |
| 65      | Finishing walls with premium acrylic smooth exterior paint with Silicon additives of required shade of approved brand and manufacture [Payment shall be made after submission of Test Certificate issued by the Manufacturer] : |          |   |              |                  |
|         | New work ( two or more coats applied @ 1.43 litre/10 sqm over and including priming coat of exterior primer applied @ 2.20 kg/10 sqm)   | 103.680  | Sqm.  | ₹ 119.30     | Sqm ₹ 12369.00   |
|         |   |          | ( Rupees One Hundred Nineteen & Paise Thirty ) Only           |              |                  |
| 66      | Supplying fitting and fixing 13 passenger lift including fitting and fixing etc.  | 1.000    | Sqm.  | ₹ 1800000.00 | Sqm ₹ 1800000.00 |
|         |   |          | ( Rupees Eighteen Lakh ) Only                                 |              |                  |
| G       | SUB-HEAD : DOORS AND DOORWAYS   |          |   | TOTAL        | ₹ 3061354.00     |



| SL. NO. | PARTICULARS OF ITEMS  | QUANTITY |      | RATE   | UNIT  | AMOUNT      |
|---------|---|----------|------|--|-------|-------------|
| 67      | Providing wood work in frames of doors, windows, clerestory windows and other frames, wrought framed and fixed in position :  | 2.250    | Cum  | ₹ 87719.70   | Cum   | ₹ 197369.00 |
|         | Local Teak Wood   |          |      | ( Rupees Eighty Seven Thousand Seven Hundred Nineteen & Paise Seventy ) Only |       |             |
| 68      | Providing and fixing ISI marked flush door shutters conforming to IS: 2202 (Part I) non-decorative type, core of block board construction with frame of 1st class hard wood and well matched commercial 3 ply veneering with vertical grains or cross bands and face veneers on both faces of shutters. |          |      |  |       |             |
|         | 35 mm thick including ISI marked Stainless Steel butt hinges with necessary screws.   | 50.400   | Sqm. | ₹ 1786.60  | Sqm.  | ₹ 90045.00  |
|         |   |          |      | ( Rupees One Thousand Seven Hundred Eighty Six & Paise Sixty ) Only          |       |             |
| 69      | Painting with synthetic enamel paint of approved brand and manufacture to give an even shade [Payment shall be made after submission of Test Certificate issued by the Manufacturer]:   |          |      |  |       |             |
|         | Two or more coats on new work   | 113.400  | Sqm. | ₹ 82.80  | Sqm.  | ₹ 9390.00   |
|         |   |          |      | ( Rupees Eighty Two & Paise Eighty ) Only                                    |       |             |
| 70      | Providing and fixing bright finished brass 100 mm mortice latch and lock ISI marked with six levers and a pair of anodised (anodic coating not less than grade AC 10 as per IS : 1868) aluminium lever handles with necessary screws etc. complete (Best make of approved quality)                      | 20.000   | No.  | ₹ 788.20   | No.   | ₹ 15764.00  |
|         |   |          |      | ( Rupees Seven Hundred Eighty Eight & Paise Twenty ) Only                    |       |             |
| 71      | Providing and fixing 50cm long aluminium kicking plate 100x3.15 mm anodised (anodic coating not less than grade AC 10 as per IS : 1868) transparent or dyed to required colour or shade with necessary screws etc. complete.  | 20.000   | No.  | ₹ 222.40   | No.   | ₹ 4448.00   |
|         |   |          |      | ( Rupees Two Hundred Twenty Two ) Only                                       |       |             |
| 72      | Providing and fixing aluminium handles ISI marked anodised (anodic coating not less than grade AC 10 as per IS : 1868) transparent or dyed to required colour or shade with necessary screws etc. complete :<br>(i) 125 mm  | 40.000   | No.  | ₹ 64.70  | No.   | ₹ 2588.00   |
|         |   |          |      | ( Rupees Sixty Four & Paise Seventy ) Only                                   |       |             |
| 73      | Providing and fixing aluminium hanging floor door stopper ISI marked anodised (anodic coating not less than grade AC 10 as per IS : 1868) transparent or dyed to required colour and shade with necessary screws etc. complete.   |          |      |  |       |             |
|         | Single rubber stopper   | 20       | Nos. | ₹ 37.20  | No.   | ₹ 744.00    |
|         |   |          |      | ( Rupees Thirty Seven & Paise Twenty ) Only                                  |       |             |
|         |   |          |      |  | TOTAL | ₹ 320348.00 |
| H       | SUB-HEAD : ACCESSIBLE TOILET  |          |      |  |       |             |



| SL. NO. | PARTICULARS OF ITEMS   | QUANTITY | RATE | UNIT       | AMOUNT  |
|---------|--|----------|------|------------|---|
| 74      | Earth work in excavation by mechanical means (Hydraulic excavator) / manual means in foundation trenches or drains (not exceeding 1.5 m in width or 10 sqm on plan) including dressing of sides and ramming of bottoms, lift upto 1.5 m, including getting out the excavated soil and disposal of surplus excavated soil as directed, within a lead of 50 m. |          |      |            |   |
|         | All kinds of soil  | 10.368   | Cum  | ₹ 169.50   | Cum   |
|         |  |          |      |            | ₹ 1757.00   |
|         |  |          |      |            | ( Rupees One Hundred Sixty Nine & Paise Fifty ) Only                    |
| 75      | Filling available excavated earth (excluding rock) in trenches, plinth, sides of foundations etc. in layers not exceeding 20cm in depth, consolidating each deposited layer by ramming and watering, lead up to 50 m and lift upto 1.5 m.  |          |      |            |   |
|         | All kinds of soil  | 6.910    | Cum  | ₹ 120.30   | Cum   |
|         |  |          |      |            | ₹ 831.00  |
|         |  |          |      |            | ( Rupees One Hundred Twenty & Paise Thirty ) Only                       |
| 76      | Supplying and filling in plinth, under floor, foundations etc. with sand (fine) from local quarry with all lifts including spreading in horizontal layers, watering, grading to required slope, ramming, consolidating and compacting each layer by using plate compactor or by any suitable method complete.  | 0.432    | Cum  | ₹ 887.50   | Cum   |
|         |  |          |      |            | ₹ 383.00  |
|         |  |          |      |            | ( Rupees Eight Hundred Eighty Seven & Paise Fifty ) Only                |
| 77      | Providing and laying in position cement concrete of specified grade excluding the cost of centring and shuttering -  |          |      |            |   |
|         | 1:4:8 ( 1 Cement: 4 fine sand : 8 graded stone aggregate 40 mm nominal size)   | 3.240    | Cum  | ₹ 9324.50  | Cum   |
|         |  |          |      |            | ₹ 30211.00  |
|         |  |          |      |            | ( Rupees Nine Thousand Three Hundred Twenty Four & Paise Fifty ) Only   |
| 78      | Providing and laying in position specified grade of reinforced cement concrete excluding the cost of centring, shuttering, finishing and reinforcement-<br>-All work upto plinth level:  |          |      |            |   |
|         | 1:1½:3 ( 1 Cement: 1½ fine sand : 3 graded stone aggregate 20 mm nominal size)   | 7.718    | Cum  | ₹ 10974.60 | Cum   |
|         |  |          |      |            | ₹ 84696.00  |
|         |  |          |      |            | ( Rupees Ten Thousand Nine Hundred Seventy Four & Paise Sixty ) Only    |
| 79      | Reinforced cement concrete work in walls (any thickness), including attached pilasters, buttresses, plinth and skirting courses, fillets, columns, pillars, piers, abutments, posts and struts etc. upto floor five level excluding cost of centring, shuttering, finishing and reinforcement-   |          |      |            |   |
|         | 1:1½:3 ( 1 Cement: 1½ fine sand : 3 graded stone aggregate 20 mm nominal size)   | 6.521    | Cum  | ₹ 11791.90 | Cum   |
|         |  |          |      |            | ₹ 76889.00  |
|         |  |          |      |            | ( Rupees Eleven Thousand Seven Hundred Ninety One & Paise Ninety ) Only |



| SL. NO. | PARTICULARS OF ITEMS  | QUANTITY |      | RATE  | UNIT | AMOUNT      |
|---------|---|----------|------|---|------|-------------|
| 80      | Reinforced cement concrete work in <b>beams, suspended floors</b> , roofs having slope upto 15° landings, balconies, shelves, chajjas, lintels, bands, plain window sills, staircases and spiral stair cases upto floor five level excluding the cost of centring, shuttering, finishing and reinforcement- |          |      |   |      |             |
|         | 1:1½:3 ( 1 Cement: 1½ fine sand : 3 graded stone aggregate 20 mm nominal size)  | 8.134    | Cum  | ₹ 12104.70  | Cum  | ₹ 98461.00  |
|         |   |          |      | ( Rupees Twelve Thousand One Hundred Four & Paise Seventy ) Only        |      |             |
| 81      | Reinforcement for R.C.C. work including straightening, cutting, bending, placing in position and binding all complete <b>upto plinth level</b> .  |          |      |   |      |             |
|         | Thermo-Mechanically Treated bars of grade Fe-500D or more   | 1389.150 | Kg.  | ₹ 78.20   | Kg.  | ₹ 108632.00 |
|         |   |          |      | ( Rupees Seventy Eight & Paise Twenty ) Only                            |      |             |
| 82      | Reinforcement for R.C.C. work including straightening, cutting, bending, placing in position and binding all complete <b>above plinth level</b> .   |          |      |   |      |             |
|         | Thermo-Mechanically Treated bars of grade Fe-500D or more   | 2637.833 | Kg.  | ₹ 78.20   | Kg.  | ₹ 206279.00 |
|         |   |          |      | ( Rupees Seventy Eight & Paise Twenty ) Only                            |      |             |
| 83      | Centering shuttering including struttings, propping etc. and removal of form work for:  |          |      |   |      |             |
| (a)     | Foundations, footings, bases for columns etc. for mass concrete with timber plank   | 12.600   | Sqm. | ₹ 268.90  | Sqm  | ₹ 3388.00   |
|         |   |          |      | ( Rupees Two Hundred Sixty Eight & Paise Ninety ) Only                  |      |             |
| b)      | Suspended floors, roofs, landings, balconies and access platform with 12 mm thick shuttering ply  | 21.863   | Sqm. | ₹ 539.00  | Sqm  | ₹ 11784.00  |
|         |   |          |      | ( Rupees Five Hundred Thirty Nine ) Only                                |      |             |
| (c)     | Lintels, beams, plinth beams, girders, bressumers and cantilevers with shuttering ply   | 23.520   | Sqm. | ₹ 385.20  | Sqm  | ₹ 9060.00   |
|         |   |          |      | ( Rupees Three Hundred Eighty Five & Paise Twenty ) Only                |      |             |
| (d)     | Columns, Pillars, Piers, Abutments, Posts and Struts with shuttering ply  | 66.240   | Sqm. | ₹ 483.00  | Sqm  | ₹ 31994.00  |
|         |   |          |      | ( Rupees Four Hundred Eighty Three ) Only                               |      |             |
|         |   |          |      |   |      |             |
| 84      | First class brick work in foundation and plinth including cost of all materials as required complete:-  |          |      |   |      |             |
| (a)     | In cement mortar 1:4 ( 1 cement : 4 fine sand ).  | 7.468    | Cum  | ₹ 8888.40   | Cum  | ₹ 66375.00  |
|         |   |          |      | ( Rupees Eight Thousand Eight Hundred Eighty Eight & Paise Forty ) Only |      |             |
| 85      | First class brick work in superstructure above plinth level & upto floor-five level including cost of all materials as required complete:-  |          |      |   |      |             |
|         | In cement mortar 1:6 ( 1 cement : 6 fine sand ).  | 51.526   | Cum  | ₹ 9859.70   | Cum  | ₹ 508035.00 |



| SL. NO. | PARTICULARS OF ITEMS  | QUANTITY | RATE   | UNIT       | AMOUNT           |
|---------|---|----------|--|------------|------------------|
|         |   |          | ( Rupees Nine Thousand Eight Hundred Fifty Nine & Paise Seventy ) Only       |            |                  |
| 86      | Half brick masonry work with first class bricks in foundation and plinth including cost of all materials as required complete:-<br>In cement mortar 1 : 4 ( 1 cement : 4 fine sand )  | 12.000   | Sqm.   | ₹ 1187.90  | Sqm ₹ 14255.00   |
|         |   |          | ( Rupees One Thousand One Hundred Eighty Seven & Paise Ninety ) Only         |            |                  |
| 87      | 12 mm cement plaster of mix   |          |  |            |                  |
| (a)     | In cement mortar 1 : 4 ( 1 cement : 4 fine sand )   | 29.400   | Sqm.   | ₹ 174.80   | Sqm. ₹ 5139.00   |
|         |   |          | ( Rupees One Hundred Seventy Four & Paise Eighty ) Only                      |            |                  |
| (b)     | In cement mortar 1 : 6 ( 1 cement : 6 fine sand )   | 101.430  | Sqm.   | ₹ 159.60   | Sqm. ₹ 16188.00  |
|         |   |          | ( Rupees One Hundred Fifty Nine & Paise Sixty ) Only                         |            |                  |
| 88      | 15 mm cement plaster on the rough side of single or half brick wall of mix:   |          |  |            |                  |
|         | Cement mortar 1:6 (1 cement : 6 fine sand)  | 101.430  | Sqm  | ₹ 185.30   | Sqm. ₹ 18795.00  |
|         |   |          | ( Rupees One Hundred Eighty Five & Paise Thirty ) Only                       |            |                  |
| 89      | 6 mm cement plaster of mix:   |          |  |            |                  |
|         | In cement mortar 1 : 3 ( 1 cement : 3 fine sand )   | 18.000   | Sqm.   | ₹ 144.50   | Sqm. ₹ 2601.00   |
|         |   |          | ( Rupees One Hundred Forty Four & Paise Fifty ) Only                         |            |                  |
| 90      | Neat cement punning.  | 6.000    | Sqm.   | ₹ 45.10    | Sqm. ₹ 271.00    |
|         |   |          | ( Rupees Forty Five & Paise Ten ) Only                                       |            |                  |
| 91      | Providing wood work in frames of doors, windows, clerestory windows and other frames, wrought framed and fixed in position :  |          |  |            |                  |
|         | Local Teak Wood   | 0.338    | Cum  | ₹ 87719.70 | Cum ₹ 29605.00   |
|         |   |          | ( Rupees Eighty Seven Thousand Seven Hundred Nineteen & Paise Seventy ) Only |            |                  |
| 92      | Providing and fixing ISI marked flush door shutters conforming to IS: 2202 (Part I) non-decorative type, core of block board construction with frame of 1st class hard wood and well matched commercial 3 ply veneering with vertical grains or cross bands and face veneers on both faces of shutters.           |          |  |            |                  |
|         | 35 mm thick including ISI marked Stainless Steel butt hinges with necessary screws.   | 10.080   | Sqm.   | ₹ 1786.60  | Sqm. ₹ 18009.00  |
|         |   |          | ( Rupees One Thousand Seven Hundred Eighty Six & Paise Sixty ) Only          |            |                  |
| 93      | Providing and fixing factory made door frame (single rebate) made of solid PVC foam profile with homogenous fine cellular structure having smooth outer integral skin having 60mm width & 30mm thickness and shall be fixed to wall as per instructions of Engineer-In-Charge using 100x8 sheet metal CSK screws. | 21.600   | Metre  | ₹ 468.80   | Metre ₹ 10126.00 |



53430/2020/SIPDA

| NO. | PARTICULARS OF ITEMS   | QUANTITY | RATE  | UNIT      | AMOUNT          |
|-----|--|----------|---|-----------|-----------------|
|     |  |          | ( Rupees Four Hundred Sixty Eight & Paise Eighty ) Only   |           |                 |
| 94  | Providing and fixing 28 mm thick door shutter made of solid PVC foam profile with homogenous fine cellular structure having smooth outer integral skin having 71mm width & 28mm thick as vertical & horizontal styles. Joints are made using solvent adhesive and GI 'C' sections (39mm x 19mm x 0.6mm thick) or M S pipe (40mm x 20mm ) stiffener frame insert & telescopic polymeric 'L' corners .The panel shall be filled with 3mm thick high - pressure compact laminate as per manufacturer's specifications and directions of the Engineer-in-charge, cover moulding shall be provided for covering fixing screws and elegant look.( for W.C. bathroom door shutter). | 10.080   | Sqm.  | ₹ 3094.40 | Sqm. ₹ 31192.00 |
|     |  |          | ( Rupees Three Thousand Ninety Four & Paise Forty ) Only  |           |                 |
| 95  | Providing and fixing bright finished brass 100 mm mortice latch and lock ISI marked with six levers and a pair of anodised (anodic coating not less than grade AC 10 as per IS : 1868) aluminium lever handles with necessary screws etc. complete (Best make of approved quality)   | 4.000    | No.   | ₹ 788.20  | No. ₹ 3153.00   |
|     |  |          | ( Rupees Seven Hundred Eighty Eight & Paise Twenty ) Only |           |                 |
| 96  | Providing and fixing 50cm long aluminium kicking plate 100x3.15 mm anodised (anodic coating not less than grade AC 10 as per IS : 1868) transparent or dyed to required colour or shade with necessary screws etc. complete.   | 4.000    | No.   | ₹ 222.40  | No. ₹ 890.00    |
|     |  |          | ( Rupees Two Hundred Twenty Two & Paise Forty ) Only      |           |                 |
| 97  | Providing and fixing aluminium handles ISI marked anodised (anodic coating not less than grade AC 10 as per IS : 1868) transparent or dyed to required colour or shade with necessary screws etc. complete :   | 8.000    | No.   | ₹ 64.70   | No. ₹ 518.00    |
|     |  |          | ( Rupees Sixty Four & Paise Seventy ) Only                |           |                 |
| 98  | Providing and fixing M.S. grills of required pattern in frames of windows etc. with M.S. flats, square or round bars etc. all complete.  |          |   |           |                 |
|     | Fixed to openings /wooden frames with rawl plugs screws etc.   | 32.400   | Kg.   | ₹ 126.40  | Kg. ₹ 4095.00   |
|     |  |          | ( Rupees One Hundred Twenty Six & Paise Forty ) Only      |           |                 |
| 99  | Providing structural steel work in single section fixed with or without connecting plate including cutting, hoisting, fixing in position and applying a priming coat of approved steel primer all complete as required.  | 32.400   | Kg.   | ₹ 82.30   | Kg. ₹ 2667.00   |
|     |  |          | ( Rupees Eighty Two & Paise Thirty ) Only                 |           |                 |

| SL. NO. | PARTICULARS OF ITEMS  | QUANTITY |      | RATE  | UNIT | AMOUNT      |
|---------|---|----------|------|---|------|-------------|
| 100     | Providing and fixing stainless steel (Grade 304) railing made of Hollow tubes, channels, plates etc., including welding, grinding, buffing, polishing and making curvature (wherever required) and fitting the same with necessary stainless steel nuts and bolts complete, including fixing the railing with necessary accessories & stainless steel dash fasteners, stainless steel bolts etc., of required size, on the top of the floor or the side of waist slab with suitable arrangement as per approval of Engineer-in-charge, (for payment purpose only weight of stainless steel members shall be considered excluding fixing accessories such as nuts, bolts, fasteners etc.). | 353.600  | Kg.  | ₹ 532.70  | Kg.  | ₹ 188363.00 |
|         |   |          |      | ( Rupees Five Hundred Thirty Two & Paise Seventy ) Only |      |             |
| 101     | Providing and fixing 1st quality ceramic glazed wall tiles (minimum 200 x 300) conforming to IS : 15622 - 2017 (thickness to be specified by the manufacturer) of approved make in all colours, shades of any size as approved by Engineer-in-charge in skirting, risers of steps and dados, laid over 12 mm thick bed of cement mortar 1 : 3 (1 cement : 3 fine sand) jointed with ordinary cement slurry including pointing with white cement mixed with pigment of matching shade complete.  | 144.480  | Sqm. | ₹ 792.00  | Sqm. | ₹ 114428.00 |
|         |   |          |      | ( Rupees Seven Hundred Ninety Two ) Only                |      |             |
| 102     | Providing and fixing Marble stone in floors over 20 mm thick bed of cement mortar 1 : 4 ( 1 cement : 4 fine sand ) jointed with ordinary cement slurry including pointing with white cement mixed with of matching shade, including rubbing and polishing complete.   |          |      |   |      |             |
|         | 18mm thick Marble Stone   |          |      |   |      |             |
|         | Rajnagar plain marble   | 28       | Sqm. | ₹ 1900.10   | Sqm. | ₹ 53203.00  |
|         |   |          |      | ( Rupees One Thousand Nine Hundred & Paise Ten ) Only   |      |             |
| 103     | Wall painting with acrylic emulsion paint of approved brand and manufacture to give an even shade [Payment shall be made after submission of Test Certificate issued by the Manufacturer] :   |          |      |   |      |             |
|         | Two or more coats on new work   | 250.26   | Sqm. | ₹ 89.60   | Sqm. | ₹ 22423.00  |
|         |   |          |      | ( Rupees Eighty Nine & Paise Sixty ) Only               |      |             |
| 104     | Applying priming coat [Payment shall be made after submission of Test Certificate issued by the Manufacturer] :   |          |      |   |      |             |
| a)      | With ready mixed Pink or Grey primer of approved brand and manufacture on wood work ( hard & soft wood ).   | 22.680   | Sqm. | ₹ 37.90   | Sqm. | ₹ 860.00    |
|         |   |          |      | ( Rupees Thirty Seven & Paise Ninety ) Only             |      |             |
| b)      | With ready mixed red oxide zinc chromate primer of approved brand and manufacture on steel galvanised iron/ steel works   | 64.800   | Sqm. | ₹ 31.70   | Sqm. | ₹ 2054.00   |
|         |   |          |      | ( Rupees Thirty One & Paise Seventy ) Only              |      |             |



| SL. NO. | PARTICULARS OF ITEMS   | QUANTITY |   | RATE       | UNIT | AMOUNT     |
|---------|--|----------|---|------------|------|------------|
| 105     | Painting with synthetic enamel paint of approved brand and manufacture to give an even shade [Payment shall be made after submission of Test Certificate issued by the Manufacturer]:  |          |   |            |      |            |
|         | Two or more coats on new work  | 87.480   | Sqm.  | ₹ 82.80    | Sqm. | ₹ 7243.00  |
|         |  |          | ( Rupees Eighty Two & Paise Eighty ) Only                               |            |      |            |
| 106     | Providing and fixing white vitreous china pedestal type water closet (European type W.C. pan) with seat and lid, 10 litre low level white P.V.C. flushing cistern with manually controlled device (handle lever), conforming to IS : 7231, with all fittings and fixtures complete including cutting and making good the walls and floors wherever required :                                      |          |   |            |      |            |
|         | W.C. pan with ISI marked white solid plastic seat and lid  | 4        | Nos.  | ₹ 4398.30  | Each | ₹ 17593.00 |
|         |  |          | ( Rupees Four Thousand Three Hundred Ninety Eight & Paise Thirty ) Only |            |      |            |
| 107     | Providing and Fixing white vitreous china flat back or wall corner type lipped front urinal basin of 430x260x350mm and 340x410x265mm sizes respectively with automatic flushing cistern with standard flush pipe and C.P. brass spreaders with brass unions and G.I clamps complete, including painting of fittings and brackets, cutting and making good the walls and floors wherever required : |          |   |            |      |            |
|         | Range of four urinal basins with 10 litre white P.V.C. automatic flushing cistern.   | 4        | Nos.  | ₹ 11482.80 | Each | ₹ 45931.00 |
|         |  |          | ( Rupees Eleven Thousand Four Hundred Eighty Two & Paise Eighty ) Only  |            |      |            |
| 108     | Providing and fixing white vitreous china wash basin including making all connections but excluding the cost of fittings:  |          |   |            |      |            |
|         | Flat back wash basin of size 550x400mm.  | 4        | Nos.  | ₹ 1139.90  | Each | ₹ 4560.00  |
|         |  |          | Hundred Thirty Nine & Paise Ninety ) Only                               |            |      |            |
| 109     | Providing and fixing toilet paper holder :<br>i) C.P. brass  | 4        | Nos.  | ₹ 436.20   | Each | ₹ 1745.00  |
|         |  |          | ( Rupees Four Hundred Thirty Six & Paise Twenty ) Only                  |            |      |            |
| 110     | Providing and fixing P.V.C. waste pipe for sink or wash basin including P.V.C. waste fittings complete.  |          |   |            |      |            |
| (a)     | Semi rigid pipe<br>32 mm dia   | 4        | Nos.  | ₹ 87.00    | Each | ₹ 348.00   |
|         |  |          | ( Rupees Eighty Seven ) Only  |            |      |            |
| (b)     | Flexible pipe<br>32 mm dia   | 4        | Nos.  | ₹ 93.90    | Each | ₹ 376.00   |
|         |  |          | ( Rupees Ninety Three & Paise Ninety ) Only                             |            |      |            |
| 111     | Providing and fixing 600x450 mm bevelled edge mirror of superior glass (of approved quality) complete with 6 mm thick hard board ground fixed to wooden cleats with C.P. brass screws and washers complete.  | 4        | Nos.  | ₹ 834.10   | Each | ₹ 3336.00  |

53430/2020/SIPDA

| SL. NO. | PARTICULARS OF ITEMS   | QUANTITY  | RATE  | UNIT     | AMOUNT     |
|---------|--|---|-------|----------|------------|
|         |  | ( Rupees Eight Hundred Thirty Four & Paise Ten) Only      |       |          |            |
| 112     | Providing and fixing 600x120x5mm glass shelf with edges round of supported on anodised aluminium angle frame with C.P. brass brackets and guard rail complete fixed with 40 mm long screws, rawl plugs etc., complete.   | 4   | Nos.  | ₹ 485.00 | Each       |
|         |  |   |       |          | ₹ 1940.00  |
|         |  | ( Rupees Four Hundred Eighty Five) Only                   |       |          |            |
| 113     | Providing and fixing PTMT liquid soap container 109mm wide, 125mm high and 112mm distance from wall of standard shape with bracket of the same materials with snap fittings of approved quality and colours weighing not less than 105 gms.  | 4   | Nos.  | ₹ 222.40 | Each       |
|         |  |   |       |          | ₹ 890.00   |
|         |  | ( Rupees Two Hundred Twenty Two & Paise Forty ) Only      |       |          |            |
| 114     | Providing and fixing PTMT towel ring trapezoidal shape 215mm long, 200mm wide with a minimum distances of 37mm from wall face with concealed fittings arrangement of approved quality and colours weighing not less than 80 gms.   | 4   | Nos.  | ₹ 261.80 | Each       |
|         |  |   |       |          | ₹ 1047.00  |
|         |  | ( Rupees Two Hundred Sixty One & Paise Eighty ) Only      |       |          |            |
| 115     | Cutting chases in brick masonry walls for following diameter sand cast iron/centrifugally cast (spun) iron pipes and making good the same with cement concrete 1:3:6 ( 1 cement : 3 coarse sand : 6 graded stone aggregate 12.5 mm nominal size ) including necessary plaster and pointing in cement mortar 1:4(1cement: 4 coarse sand): |   |       |          |            |
|         | 100 mm dia.  | 2 000   | Metre | ₹ 337.90 | Metre      |
|         |  |   |       |          | ₹ 676.00   |
|         |  | ( Rupees Three Hundred Thirty Seven & Paise Ninety ) Only |       |          |            |
| 116     | Providing and fixing soil, waste and vent pipes: (i) 100 mm dia.<br>- Sand cast iron S&S pipe as per IS: 1729  | 40.000  | Metre | ₹ 882.00 | Metre      |
|         |  |   |       |          | ₹ 35280.00 |
|         |  | ( Rupees Eight Hundred Eighty Two) Only                   |       |          |            |
| 117     | Providing and fixing on wall face unplasticised Rigid PVC rain water, soil, waste & vent pipes (working pressure 6 kg / cm <sup>2</sup> ) conforming to IS : 13592 Type A including jointing with seal ring conforming to IS : 5382 leaving 10 mm gap for thermal expansion:   |   |       |          |            |
|         | Single socketed pipe - 110 mm OD   | 111.000   | Metre | ₹ 321.20 | Metre      |
|         |  |   |       |          | ₹ 35653.00 |
|         |  | ( Rupees Three Hundred Twenty One & Paise Twenty ) Only   |       |          |            |
| 118     | Providing and fixing on wall face unplasticised - PVC moulded fittings/ accessories for unplasticised Rigid PVC rain water, soil, waste & vent pipes conforming to IS : 13592 Type A including jointing with seal ring conforming to IS : 5382 leaving 10 mm gap for thermal expansion:  |   |       |          |            |
| (a)     | Coupler  |   |       |          |            |
|         | 110mm  | 37  | Nos.  | ₹ 123.60 | Each       |
|         |  |   |       |          | ₹ 4573.00  |



| SL. NO. | PARTICULARS OF ITEMS  | QUANTITY | RATE  | UNIT       | AMOUNT |            |
|---------|---|----------|---|------------|--------|------------|
|         |   |          | ( Rupees One Hundred Twenty Three & Paise Sixty ) Only                |            |        |            |
| ( b )   | Single equal tee with door<br>110 x 110 x 110 mm  | 15       | Nos.  | ₹ 231.20   | Each   | ₹ 3468.00  |
|         |   |          | ( Rupees Two Hundred Thirty One & Paise Twenty ) Only                 |            |        |            |
| ( c )   | Single equal tee without door<br>110 x 110 x 110 mm   | 15       | Nos.  | ₹ 224.40   | Each   | ₹ 3366.00  |
|         |   |          | ( Rupees Two Hundred Twenty Four & Paise Forty ) Only                 |            |        |            |
| ( d )   | Bend 87.5<br>110mm  | 15       | Nos.  | ₹ 140.90   | Each   | ₹ 2114.00  |
|         |   |          | ( Rupees One Hundred Forty & Paise Ninety ) Only                      |            |        |            |
| ( e )   | Double equal junction of required degree without door<br>110x110x110 x110 mm  | 15       | Nos.  | ₹ 204.40   | Each   | ₹ 3066.00  |
|         |   |          | ( Rupees Two Hundred Four & Paise Forty ) Only                        |            |        |            |
| f)      | Double equal junction of required degree with door  | 15       | Nos.  | ₹ 246.60   | Each   | ₹ 3699.00  |
|         |   |          | ( Rupees Two Hundred Forty Six & Paise Sixty ) Only                   |            |        |            |
| g       | Providing and fixing terminal guard:<br>(i) 100 mm<br>- Sand cast iron S&S as per IS - 1729   | 15       | Nos.  | ₹ 334.10   | Each   | ₹ 5012.00  |
|         |   |          | ( Rupees Three Hundred Thirty Four & Paise Ten ) Only                 |            |        |            |
| 119     | Providing and fixing unplasticised -PVC pipe clips of approved design to unplasticised - PVC rain water, soil, waste & vent pipes by means of 50x50x50mm hard wood plugs, screwed with M.S. screws of required length including cutting brick work and fixing with cement mortar 1 : 4 (1cement : 4 fine sand) making good the wall etc. complete.<br>(i) 100 mm    | 74       | Nos.  | ₹ 190.50   | Each   | ₹ 14097.00 |
|         |   |          | ( Rupees One Hundred Ninety & Paise Fifty ) Only                      |            |        |            |
| 120     | Providing and fixing white vitreous china extended wall mounting water closet of size 780x370x690 mm of approved shape including providing & fixing white vitreous china cistern with dual flush fitting, of flushing capacity 3 litre/ 6 litre (adjustable to 4 litre/ 8 litres), including seat cover, and cistern fittings, nuts, bolts and gasket etc complete. | 4        | Nos.  | ₹ 13215.70 | Each   | ₹ 52863.00 |
|         |   |          | ( Rupees Thirteen Thousand Two Hundred Fifteen & Paise Seventy ) Only |            |        |            |

53430/2020/SIPDA

| SL. NO. | PARTICULARS OF ITEMS   | QUANTITY | RATE          | UNIT   | AMOUNT                             |
|---------|--|----------|---------------|--|------------------------------------|
| 121     | Supplying , fitting and fixing and installation of chest support grab bar urinal metal etc complete.   | 4        | Mtr           | ₹ 6411.00  | Mtr. ₹ 25644.00                    |
|         |  |          |               | ( Rupees Six Thousand Four Hundred Eleven ) Only         |                                    |
| 122     | Supplying , fitting and fixing and installation of foldable grab bar near water closet wash basin etc complete   | 4        | Mtr           | ₹ 6200.00  | Mtr. ₹ 24800.00                    |
|         |  |          |               | ( Rupees Six Thousand Two Hundred ) Only                 |                                    |
|         |  |          |               | <b>TOTAL</b>   | <b>₹ 2076930.00</b>                |
| I       | <b>SUB-HEAD : DRINKING WATER</b>   |          |               |  |                                    |
| 123     | Supplying fitting and fixing sensor faucet of Jaquar brand etc complete.   | 4        | No.           | ₹ 11535.00   | Each ₹ 46140.00                    |
|         |  |          |               | ( Rupees Eleven Thousand Five Hundred Thirty Five ) Only |                                    |
|         |  |          |               | <b>TOTAL</b>   | <b>₹ 46140.00</b>                  |
| J       | <b>SUB-HEAD : CONTROL AND OPERATING MECHANISM</b>  |          |               |  |                                    |
| 124     | Plinth area of the Building  |          |               |  |                                    |
|         | Ground Floor Area  | 1421     | Sqm           | ₹ 30058.00   | ₹ 42712418.00                      |
|         |  |          |               | ( Rupees Thirty Thousand Fifty Eight ) Only              |                                    |
|         | First Floor Area   | 1207     | Sqm           | ₹ 19241.00   | ₹ 23223887.00                      |
|         |  |          |               | ( Rupees Nineteen Thousand Two Hundred Forty One ) Only  |                                    |
|         |  |          |               | <b>TOTAL</b>   | <b>₹ 65936305.00</b>               |
|         | For Internal Electrification Add 5% from the Plinth area Cost amount of Building   |          |               |  | ₹ 3296815.00                       |
|         |  |          |               | <b>TOTAL</b>   | <b>₹ 3296815.00</b>                |
| K       | <b>SUB-HEAD : SIGNAGE</b>  |          |               |  |                                    |
| 125     | Direction and Place Identification Signs upto 0.9 sqm Size Board.<br>Providing and erecting direction and place identification retro-reflectorised sign as per IRC:67 made of high intensity grade sheeting vide clause 801.3, fixed over aluminium sheeting, 2 mm thick with area not exceeding 0.9 sqm supported on a mild steel single angle iron post 75 x 75 x 6 mm firmly fixed to the ground by means of properly designed foundation with M15 grade cement concrete 450 x 450 x 600 mm, 600 mm below ground level as per approved drawing and MoRT&H Technical Specification Clause 801. | 15       | No.           | ₹ 11535.00   | Each ₹ 173025.00                   |
|         |  |          |               | ( Rupees Eleven Thousand Five Hundred Thirty Five ) Only |                                    |
| 126     | Printing New Letters and Figures of any Shade<br><br>Printing new letter and figures of any shade with synthetic enamel paint black or any other approved colour to give an even shade as per drawings and MoRT&H Technical Specification Clause 801.  |          |               |  |                                    |
|         | (i) Hindi  | 3000.000 | Per cm        | ₹ 1.00   | Per cm height ₹ 3000.00            |
|         |  |          |               | ( Rupee One ) Only                                       |                                    |
|         | (ii) English, Bengali and Kokborok   | 3000.000 | cm height per | ₹ 0.60   | Per cm height per letter ₹ 1800.00 |
|         |  |          |               | & Paise Sixty ) Only                                     |                                    |



01-06-2020  
Executive Engineer,  
Project Unit, PWD (Buildings),  
New Secretariat Building,  
Block-7, 2nd Floor,  
Agartala, Tripura.



53430/2020/SIPDA

Proposed construction for creation of barrier free environment for the benefit of persons with Disabilities under the Accessible India Campaign(AIC) in different State Government buildings of Tripura /Proposed Remodel/Reorientation of rooms of existing Belonia Court Building, Belonia, South Tripura.

| DETAILED CALCULATION |                |   |     |   |        |   |       |              |               |
|----------------------|----------------|---|-----|---|--------|---|-------|--------------|---------------|
| <b>A</b>             | <b>A</b>       | <b>SUB-HEAD : PARKING</b>   |     |   |        |   |       |              |               |
| <b>1</b>             | <b>2.13</b>    | Earth work in excavation by mechanical means (Hydraulic excavator) / manual means in foundation trenches or drains (not exceeding 1.5 m in width or 10 sqm on plan) including dressing of sides and ramming of bottoms, lift upto 1.5 m, including getting out the excavated soil and disposal of surplus excavated soil as directed, within a lead of 50 m.  |     |   |        |   |       |              |               |
|                      |                | All kinds of soil   | 8   | x | 1.200  | x | 1.200 | x            | 1.200 =       |
|                      |                |   |     |   |        |   |       |              | 13.824        |
|                      |                |   |     |   |        |   |       | <b>TOTAL</b> | <b>13.824</b> |
| <b>2</b>             | <b>2.16</b>    | Filling available excavated earth (excluding rock) in trenches, plinth, sides of foundations etc. in layers not exceeding 20cm in depth, consolidating each deposited layer by ramming and watering, lead up to 50 m and lift upto 1.5 m.   |     |   |        |   |       |              |               |
|                      |                | All kinds of soil   |     |   |        |   |       |              |               |
|                      |                | Vide Item (1)   | 2/3 | x | 13.824 |   |       |              |               |
|                      |                |   |     |   |        |   |       | <b>TOTAL</b> | <b>9.220</b>  |
| <b>3</b>             | <b>2.18</b>    | Supplying and filling in plinth, under floor, foundations etc. with sand (fine) from local quarry with all lifts including spreading in horizontal layers, watering, grading to required slope, ramming, consolidating and compacting each layer by using plate compactor or by any suitable method complete.   |     |   |        |   |       |              |               |
|                      | <b>i</b>       | Woman's College   |     |   |        |   |       |              |               |
|                      |                | foundation  | 8   | x | 1.200  | x | 1.200 | x            | 0.075 =       |
|                      |                | floor   | 1   | x | 6.000  | x | 8.000 | x            | 0.150 =       |
|                      |                |   |     |   |        |   |       |              | 0.860         |
|                      |                |   |     |   |        |   |       | <b>TOTAL</b> | <b>7.200</b>  |
| <b>4</b>             | <b>9.12</b>    | Steel work in built up tubular (round, square or rectangular hollow tubes etc.) trusses etc., including cutting, hoisting, fixing in position and applying a priming coat of approved steel primer, including welding and bolted with special shaped washers etc.   |     |   |        |   |       |              |               |
|                      | <b>9.12.1</b>  | Hot finished welded type tubes  |     |   |        |   |       |              |               |
|                      |                | parking   | 2   | x | 3.350  | x | 8.000 |              | 25kg/sqr =    |
|                      |                |   |     |   |        |   |       |              | 1340.000      |
|                      |                |   |     |   |        |   |       |              | 1340.000      |
| <b>5</b>             | <b>11.15</b>   | Supply & installation of pre-painted Galvalume sheets for roofing/cladding (size, shape and pitch of corrugation as approved by Engineer-in-charge) in 550mpa steel grade, made out of Cold Rolled Steel coated with Zinc-Aluminium alloy coating of 43.5% Zn, 55% Al and 1.5% Silicon confirming to ASTM A792/A792M and AS1397, Alloy coating AZ150/AZ70, colour coated with high quality Polyester coating, top coated of modified polyester of 20 micron, back side coat of 5 micron, having epoxy primer coat of 5 micron on both side. Sheet should have protective guard film of 25 microns minimum to avoid scratches while transportation and should be supplied in single length upto 12 metre or as desired by Engineer-in-charge. The sheet shall be fixed using self drilling /self tapping screws of size (5.5x 55mm) with EPDM washers filled with white lead complete upto any pitch in horizontal/vertical or curved surfaces excluding the cost of purlins, rafters and trusses and including cutting to size and shape wherever required. |     |   |        |   |       |              |               |
|                      | <b>11.15.2</b> | 0.45mm thickness  |     |   |        |   |       |              |               |
|                      |                | parking   | 2   | x | 3.850  | x | 9.000 |              |               |
|                      |                |   |     |   |        |   |       |              | 69.300        |
|                      |                |   |     |   |        |   |       | <b>TOTAL</b> | <b>69.30</b>  |
| <b>6</b>             | <b>11.16</b>   | Supply & installation of pre-painted Galvalume sheets roofing accessories in 550mpa steel steel grade, made out of Cold rolled steel coated with Zinc-Aluminium alloy coating of 43.5% Zn, 55% Al and 1.5% Silicon confirming to AASTM A792/A792M and AS1397, Alloy coating AZ150/AZ70, colour coated with high quality polyester coating, top coated of modified polyester of 20 micron, back side coat of 5 micron, having epoxy primer coat of 5 micron on both side. Sheet should have protective guard film of 25 microns minimum to avoid scratches while transportation. The sheet shall be fixed using self drilling /self tapping screws with EPDM washers complete for Ridges/Valley/Gutter/Flashing of width 610mm:  |     |   |        |   |       |              |               |
|                      | <b>11.16.1</b> | 0.45mm thickness  |     |   |        |   |       |              |               |
|                      |                |   |     |   |        |   |       |              | 9.00          |
| <b>7</b>             | <b>4.1</b>     | Providing and laying in position cement concrete of specified grade excluding the cost of centring and shuttering -   |     |   |        |   |       |              |               |
|                      | <b>a)</b>      | <b>4.1.7</b> 1:4:8 ( 1 Cement: 4 fine sand : 8 graded stone aggregate 40 mm nominal size)   |     |   |        |   |       |              |               |
|                      |                | footing   | 8   | x | 1.200  | x | 1.200 | x            | 0.100 =       |
|                      |                | floor   | 1   | x | 6.000  | x | 8.000 | x            | 0.150 =       |
|                      |                |   |     |   |        |   |       |              | 1.150         |
|                      |                | Additional 20%  |     |   |        |   |       |              | 7.200         |
|                      |                |   |     |   |        |   |       |              | 8.350         |
|                      |                |   |     |   |        |   |       |              | 1.670         |
| <b>8</b>             | <b>4.4</b>     | Centering shuttering including struttings, propping etc. and removal of form work for:  |     |   |        |   |       |              |               |
|                      | <b>4.4.1</b>   | Foundations, footings, bases for columns.   |     |   |        |   |       |              |               |
|                      |                | Isolated Footing  | 8   | x | 1.200  | + | 1.200 | x            | 0.100 x 2     |
|                      |                |   |     |   |        |   |       |              | 3.84          |
|                      |                |   |     |   |        |   |       | <b>TOTAL</b> | <b>3.840</b>  |
| <b>9</b>             | <b>4.17</b>    | Making plinth protection 50mm thick of cement concrete 1:3:6 (1 cement : 3 fine sand : 6 graded well burnt brick aggregate 20 mm nominal size) over 75mm bed of dry brick ballast 40mm nominal size well rammed and consolidated and grouted with fine sand including finishing the top smooth.   |     |   |        |   |       |              |               |
|                      |                | Along plinth side drain   | 1   | x | 30.000 | x | 1.000 |              |               |
|                      |                |   |     |   |        |   |       |              | 30.000        |



31



53436/2020/SIPDA

Providing and fixing tactile of standardized designs conforming to RNIB (The Royal National Institute for the Blind, UK), DETR (Department of the Environment, Transport and the Regions, UK) & ADA (Americans with Disabilities Act, USA) of size 300 x 300 mm in floors, (thickness to be specified by the manufacturer) specially designed to assist the visually impaired - "foot braille", with water absorption less than 0.5%, of approved brand & manufacturer, laid on 20 mm thick bed of cement mortar 1 : 4 ( 1 cement : 4 fine sand ) including grouting of joints (Payment for grouting of joints to be made separately)

|   |   |   |        |   |       |   |          |
|---|---|---|--------|---|-------|---|----------|
| internal road to parking                          | 1 | x | 6.525  | x | 0.300 | = |          |
| from internal road to front entrance ramp & stair | 1 | x | 24.100 | x | 0.300 | = | 1.958    |
| parking   | 1 | x | 4.900  | x | 0.300 | = | 7.230    |
| add 15% extra for room entrance guiding           |   |   |        |   |       |   | 1.470    |
|   |   |   |        |   |       |   | 10.658   |
|   |   |   |        |   |       |   | 1.598625 |

**TOTAL = 12.256**

**C SUB-HEAD : ACCESSIBLE ROUTE**

20 2.13 Earth work in excavation by mechanical means (Hydraulic excavator) / manual means in foundation trenches or drains (not exceeding 1.5 m in width or 10 sqm on plan) including dressing of sides and ramming of bottoms, lift upto 1.5 m, including getting out the excavated soil and disposal of surplus excavated soil as directed, within a lead of 50 m.

All kinds of soil

isolated footings for corridor 6 x 1.500 x 1.500 x 1.500 = 20.250

**TOTAL = 20.250**

21 2.16 Filling available excavated earth (excluding rock) in trenches, plinth, sides of foundations etc. in layers not exceeding 20cm in depth, consolidating each deposited layer by ramming and watering, lead up to 50 m and lift upto 1.5 m.

All kinds of soil

Vide Item (49) 2/3 x 20.250

**TOTAL = 13.500**

22 2.18 Supplying and filling in plinth, under floor, foundations etc. with sand (fine) from local quarry with all lifts including spreading in horizontal layers, watering, grading to required slope, ramming, consolidating and compacting each layer by using plate compactor or by any suitable method complete.

isolated footings 6 x 1.500 x 1.500 x 0.100 = 1.350

**TOTAL = 1.350**

23 4.1 Providing and laying in position cement concrete of specified grade excluding the cost of centring and shuttering -

a) 4.1.7 1:4:8 ( 1 Cement: 4 fine sand : 8 graded stone aggregate 40 mm nominal size)

footing 6 x 1.500 x 1.500 x 0.100 = 1.350

floor 1 x 13.500 x 3.000 x 0.150 = 6.075

Additional 20% 7.425

**TOTAL = 1.485**

24 4.4 Centering shuttering including struttings, propping etc. and removal of form work for:

4.4.1 Foundations, footings, bases for columns.

Isolated Footing

6 x ( 1.500 + 1.500 ) x 0.100 x 2 = 3.60

**TOTAL = 3.600**

25 5.1.2 Providing and laying in position specified grade of reinforced cement concrete excluding the cost of centring, shuttering, finishing and reinforcement-

-All work upto plinth level:

1:1½:3 ( 1 Cement: 1½ fine sand : 3 graded stone aggregate 20 mm nominal size)

isolated footings column 6 x 1.500 x 1.500 x 0.450 = 6.075

6 x 0.350 x 0.450 x 1.450 = 1.370

**TOTAL = 7.445**

26 5.2.2 Reinforced cement concrete work in walls (any thickness), including attached pilasters, buttresses, plinth and skirting courses, fillets, columns, pillars, piers, abutments, posts and struts etc. upto floor five level excluding cost of centring, shuttering, finishing and reinforcement-

1:1½:3 ( 1 Cement: 1½ fine sand : 3 graded stone aggregate 20 mm nominal size)

column 6 x 0.350 x 0.450 x 7.200 = 6.804

**TOTAL = 6.804**

27 5.3.1 Reinforced cement concrete work in beams, suspended floors, roofs having slope upto 15° landings, balconies, shelves, chajjas, lintels, bands, plain window sills, staircases and spiral stair cases upto floor five level excluding the cost of centring, shuttering, finishing and reinforcement-

1:1½:3 ( 1 Cement: 1½ fine sand : 3 graded stone aggregate 20 mm nominal size)

RCC work in slab,

Corridor SLAB beam 2 x 13.500 x 3.000 x 0.150 = 12.150

2 x 13.500 x 0.300 x 0.400 = 3.240

lintel 10 x 3.000 x 0.300 x 0.300 = 2.700

2 x 13.500 x 0.300 x 0.200 = 1.620

**TOTAL = 19.710**

28 5.19 Reinforcement for R.C.C. work including straightening, cutting, bending, placing in position and binding all complete upto plinth level.

Thermo-Mechanically Treated bars of grade Fe-500D or more

Total RCC 7.445 180.00 = 1340.145

**TOTAL = 1340.145**



53430/2020/SIPDA

|    |         |  |        |                             |         |          |       |       |       |         |  |         |
|----|---------|--|--------|-----------------------------|---------|----------|-------|-------|-------|---------|--|---------|
| 29 | 5.20    | Reinforcement for R.C.C. work including straightening, cutting, bending, placing in position and binding all complete above plinth level.  |        |                             |         |          |       |       |       |         |  |         |
|    |         | Thermo-Mechanically Treated bars of grade Fe-500D or more  |        |                             |         |          |       |       |       |         |  |         |
|    |         | Total RCC  | 19.710 | 180.00                      | =       | 3547.800 |       |       |       |         |  |         |
|    |         |  | 6.804  | 180.00                      | =       | 1224.720 |       |       |       |         |  |         |
|    |         |  |        |                             | TOTAL = | 4772.520 |       |       |       |         |  |         |
| 30 | 5.9     | Centering shuttering including struttings, propping etc. and removal of form work for:   |        |                             |         |          |       |       |       |         |  |         |
| a) | 5.9.1.  | Foundations, footings, bases for columns etc. for mass concrete with timber plank  |        |                             |         |          |       |       |       |         |  |         |
|    | 1       |  | 4      | x ( 1.200 + 1.200 ) x 0.150 | x       | 2        | =     | 2.880 |       |         |  |         |
|    |         |  |        |                             | TOTAL = |          |       | 2.880 |       |         |  |         |
| b) | 5.9.4.  | Suspended floors, roofs, landings, balconies and access platform with 12 mm thick shuttering ply   |        |                             |         |          |       |       |       |         |  |         |
|    | 2       |  |        |                             |         |          |       |       |       |         |  |         |
|    |         | Corridor Slab  | 2      | x                           | 13.500  | x        | 3.000 | x     | 1.000 |         |  | 81.000  |
|    |         |  |        |                             |         |          |       |       |       | TOTAL = |  | 81.000  |
| c) | 5.9.5.  | Lintels, beams, plinth beams, girders, bressumers and cantilevers with shuttering ply  |        |                             |         |          |       |       |       |         |  |         |
|    |         | roof beam  | 2      | x                           | 13.500  | x        | 2     | x     | 0.400 |         |  | 21.600  |
|    |         |  | 10     | x                           | 3.000   | x        | 2     | x     | 0.300 |         |  | 18.000  |
|    |         | lintel   | 2      | x                           | 13.500  | x        | 2     | x     | 0.200 |         |  | 10.800  |
|    |         |  |        |                             |         |          |       |       |       | TOTAL = |  | 50.400  |
| d) | 5.9.6.2 | Columns, Pillars, Piers, Abutments, Posts and Struts with wooden plank   |        |                             |         |          |       |       |       |         |  |         |
|    |         | columns (total ht.)  | Ht.    |                             | (b+d)   |          | Nos   |       |       |         |  |         |
|    |         | Column   | 7.20   | x ( 0.350 + 0.450 ) x 2     | x       | 6        |       |       |       | Total = |  | 69.12   |
|    |         |  |        |                             |         |          |       |       |       |         |  | 69.120  |
| 31 | 6.12    | Half brick masonry work with first class bricks in superstructure upto floor five level including cost of all materials as required complete:-   |        |                             |         |          |       |       |       |         |  |         |
|    | 6.12.3  | In cement mortar 1:4 ( 1 cement : 4 fine sand ).   |        |                             |         |          |       |       |       |         |  |         |
|    |         |  | 2      | x                           | 13.500  | x        | 0.900 |       |       |         |  | 24.300  |
|    |         |  |        |                             |         |          |       |       |       | TOTAL = |  | 24.300  |
| 32 | 12.1    | 12 mm cement plaster of mix  |        |                             |         |          |       |       |       |         |  |         |
| a) | 12.1.4  | In cement mortar 1 : 6 ( 1 cement : 6 fine sand )  |        |                             |         |          |       |       |       |         |  |         |
|    |         |  | 2      | x                           | 13.500  | x        | 0.900 | x     | 2.000 | =       |  | 48.600  |
|    |         |  |        |                             |         |          |       |       |       | TOTAL = |  | 48.600  |
| 33 | 12.4    | 6 mm cement plaster of mix:  |        |                             |         |          |       |       |       |         |  |         |
|    | 12.4.1  | In cement mortar 1 : 3 ( 1 cement : 3 fine sand )  |        |                             |         |          |       |       |       |         |  |         |
|    |         | Corridor ceiling   | 2      | x                           | 13.500  | x        | 3.000 |       |       |         |  | 81.00   |
|    |         | columns  | 6      | x                           | 1.600   | x        | 7.200 |       |       |         |  | 69.12   |
|    |         |  |        |                             |         |          |       |       |       | TOTAL = |  | 150.120 |
| 34 | 12.24   | Distempering with oil bound washable distemper of approved brand and manufacture and of required shade on new work ( two or more coats ), over and including water thinnable priming coat to give an even shade. [Payment shall be made after submission of Test Certificate issued by the Manufacturer]   |        |                             |         |          |       |       |       |         |  |         |
|    |         | Corridor ceiling   | 2      | x                           | 13.500  | x        | 3.000 |       |       |         |  | 81.00   |
|    |         | b/w  | 2      | x                           | 13.500  | x        | 0.900 |       |       |         |  | 24.30   |
|    |         |  |        |                             |         |          |       |       |       | TOTAL = |  | 105.300 |
| 35 | 12.31   | Finishing walls with premium acrylic smooth exterior paint with Silicon additives of required shade of approved brand and manufacture [Payment shall be made after submission of Test Certificate issued by the Manufacturer] :  |        |                             |         |          |       |       |       |         |  |         |
|    |         | New work ( two or more coats applied @ 1.43 litre/10 sqm over and including priming coat of exterior primer applied @ 2.20 kg/10 sqm )   |        |                             |         |          |       |       |       |         |  |         |
|    |         | columns  | 6      | x                           | 1.600   | x        | 7.200 |       |       |         |  |         |
|    |         |  | 2      | x                           | 13.500  | x        | 0.900 |       |       |         |  |         |
|    |         |  |        |                             |         |          |       |       |       | TOTAL = |  | 24.30   |
| 36 | 10.28   | Providing and fixing Marble stone in floors over 20 mm thick bed of cement mortar 1 : 4 ( 1 cement : 4 fine sand ) jointed with ordinary cement slurry including pointing with white cement mixed with of matching shade, including rubbing and polishing complete.  |        |                             |         |          |       |       |       |         |  |         |
|    |         | 18 mm thick Marble stone   |        |                             |         |          |       |       |       |         |  |         |
|    | 10.28.  | Raj Nagar plain marble   |        |                             |         |          |       |       |       |         |  |         |
|    | 1.2     |  |        |                             |         |          |       |       |       |         |  |         |
|    |         | corridor   | 1      | x                           | 13.500  | x        | 3.000 |       |       |         |  | 40.50   |
|    |         |  |        |                             |         |          |       |       |       | TOTAL = |  | 40.50   |
| 37 | 10.47   | Providing and fixing tactiles of standardized designs conforming to RNIB (The Royal National Institute for the Blind, UK), DETR (Department of the Environment, Transport and the Regions, UK) & ADA (Americans with Disabilities Act, USA) of size 300 x 300 mm in floors, (thickness to be specified by the manufacturer) specially designed to assist the visually impaired - "foot braille", with water absorption less than 0.5%, of approved brand & manufacturer, laid on 20 mm thick bed of cement mortar 1 : 4 ( 1 cement : 4 fine sand ) including grouting of joints (Payment for grouting of joints to be made separately) |        |                             |         |          |       |       |       |         |  |         |
|    |         | GF   |        |                             |         |          |       |       |       |         |  |         |
|    |         | corridor   | 1      | x                           | 95.000  | x        | 0.3   |       |       |         |  | 28.5    |
|    |         | add 15% extra for room entrance guiding  |        |                             |         |          |       |       |       |         |  | 4.275   |
|    |         |  |        |                             |         |          |       |       |       |         |  | 32.775  |
|    |         |  |        |                             |         |          |       |       |       |         |  | 32.775  |
|    | ii      | FF   |        |                             |         |          |       |       |       |         |  |         |
|    |         | corridor   | 1      | x                           | 92.100  | x        | 0.3   |       |       |         |  | 27.63   |



Generated from eOffice by RAHUL MEHRA, Cons.-(SIPDA)-RM, CONSULTANT, DEPWD on 30/11/2022 09:53 AM



53430/2020/SIPDA

|                                  |       |   |     |   |        |   |       |                |                 |
|----------------------------------|-------|---|-----|---|--------|---|-------|----------------|-----------------|
| <b>E SUB-HEAD : STEPS/STAIRS</b> |       |   |     |   |        |   |       |                |                 |
| 47                               | 9.22  | Providing and fixing stainless steel (Grade 304) railing made of Hollow tubes, channels, plates etc., including welding, grinding, buffing, polishing and making curvature (wherever required) and fitting the same with necessary stainless steel nuts and bolts complete, including fixing the railing with necessary accessories & stainless steel dash fasteners, stainless steel bolts etc., of required size, on the top of the floor or the side of waist slab with suitable arrangement as per approval of Engineer-in-charge, (for payment purpose only weight of stainless steel members shall be considered excluding fixing accessories such as nuts, bolts, fasteners etc.). |     |   |        |   |       |                |                 |
|                                  | i     | staircase   | 2   | x | 19.800 | x | 4     | @ 6.5kg/m =    | 1029.600        |
|                                  |       | staircase   | 2   | x | 1.800  | x | 4     | @ 6.5kg/m =    | 93.600          |
|                                  |       |   | 1   | x | 0.900  | x | 2     | @ 6.5kg/m =    | 11.700          |
|                                  |       |   |     |   |        |   |       | <b>TOTAL =</b> | <b>1134.900</b> |
| 48                               |       | Providing Contrast strips for steps 150 cm x 20 cm including fitting, fixing etc  |     |   |        |   |       |                |                 |
|                                  | i     | stairs  | 8   | x | 11     | x | 1.65  | x 1.000        | 145.200         |
|                                  |       |   | 4   | x | 11     | x | 2.00  | x 1.000        | 88.000          |
|                                  |       |   | 1   | x | 3      | x | 3.00  | x 1.000        | 9.000           |
|                                  |       |   |     |   |        |   |       | <b>TOTAL =</b> | <b>242.200</b>  |
| 49                               | 10.47 | Providing and fixing tactile of standardized designs conforming to RNIB (The Royal National Institute for the Blind, UK), DETR (Department of the Environment, Transport and the Regions, UK) & ADA (Americans with Disabilities Act, USA) of size 300 x 300 mm in floors, (thickness to be specified by the manufacturer) specially designed to assist the visually impaired - "foot braille", with water absorption less than 0.5%, of approved brand & manufacturer, laid on 20 mm thick bed of cement mortar 1 : 4 ( 1 cement : 4 fine sand ) including grouting of joints (Payment for grouting of joints to be made separately)   |     |   |        |   |       |                |                 |
|                                  | i     | after each flight of staircase  | 4   | x | 2      | x | 0.30  | x 3.000        | 7.200           |
|                                  |       |   | 2   | x | 2      | x | 0.30  | x 4.000        | 4.800           |
|                                  |       |   |     |   |        |   |       | <b>TOTAL =</b> | <b>12.000</b>   |
| <b>F SUB-HEAD : LIFTS</b>        |       |   |     |   |        |   |       |                |                 |
| 50                               | 2.13  | Earth work in excavation by mechanical means (Hydraulic excavator) / manual means in foundation trenches or drains (not exceeding 1.5 m in width or 10 sqm on plan) including dressing of sides and ramming of bottoms, lift upto 1.5 m, including getting out the excavated soil and disposal of surplus excavated soil as directed, within a lead of 50 m.  |     |   |        |   |       |                |                 |
|                                  |       | All kinds of soil   | 1   | x | 2.500  | x | 1.900 | x 1.500 =      | 7.125           |
|                                  |       | lift well   | 4   | x | 1.500  | x | 1.500 | x 1.500 =      | 13.500          |
|                                  |       | isolated footings   |     |   |        |   |       | <b>TOTAL =</b> | <b>20.625</b>   |
| 51                               | 2.16  | Filling available excavated earth (excluding rock) in trenches, plinth, sides of foundations etc. in layers not exceeding 20cm in depth, consolidating each deposited layer by ramming and watering, lead up to 50 m and lift upto 1.5 m.   |     |   |        |   |       |                |                 |
|                                  |       | All kinds of soil   | 2/3 | x | 20.625 |   |       |                | 13.750          |
|                                  |       | Vide Item (49)  |     |   |        |   |       | <b>TOTAL =</b> | <b>13.750</b>   |
| 52                               | 2.18  | Supplying and filling in plinth, under floor, foundations etc. with sand (fine) from local quarry with all lifts including spreading in horizontal layers, watering, grading to required slope, ramming, consolidating and compacting each layer by using plate compactor or by any suitable method complete.   |     |   |        |   |       |                |                 |
|                                  |       | lift well   | 1   | x | 2.500  | x | 1.900 | x 0.100 =      | 0.475           |
|                                  |       | isolated footings   | 4   | x | 1.500  | x | 1.500 | x 0.100 =      | 0.900           |
|                                  |       |   |     |   |        |   |       | <b>TOTAL =</b> | <b>1.375</b>    |
| 53                               | 4.1   | Providing and laying in position cement concrete of specified grade excluding the cost of centring and shuttering -   |     |   |        |   |       |                |                 |
| a)                               | 4.1.7 | 1:4:8 ( 1 Cement: 4 fine sand : 8 graded stone aggregate 40 mm nominal size)  |     |   |        |   |       |                |                 |
|                                  |       | footing   | 4   | x | 1.500  | x | 1.500 | x 0.100 =      | 0.900           |
|                                  |       | floor   | 1   | x | 2.500  | x | 1.900 | x 0.150 =      | 0.713           |
|                                  |       |   |     |   |        |   |       | <b>1.613</b>   |                 |
|                                  |       | Additional 20%  |     |   |        |   |       | <b>0.323</b>   |                 |
|                                  |       |   |     |   |        |   |       | <b>TOTAL =</b> | <b>1.935</b>    |
| 54                               | 4.4   | Centering shuttering including struttings, propping etc. and removal of form work for:  |     |   |        |   |       |                |                 |
|                                  | 4.4.1 | Foundations, footings, bases for columns.   |     |   |        |   |       |                |                 |
|                                  |       | Isolated Footing  | 4   | x | 1.500  | x | 1.500 | x 0.100 x 2    | 2.40            |
|                                  |       |   |     |   |        |   |       | <b>TOTAL</b>   | <b>2.400</b>    |
| 55                               | 5.1.2 | Providing and laying in position specified grade of reinforced cement concrete excluding the cost of centring, shuttering, finishing and reinforcement--  |     |   |        |   |       |                |                 |
|                                  |       | All work upto plinth level:   |     |   |        |   |       |                |                 |
|                                  |       | 1:1½:3 ( 1 Cement: 1½ fine sand : 3 graded stone aggregate 20 mm nominal size)  |     |   |        |   |       |                |                 |
|                                  |       | lift well   | 1   | x | 2.500  | x | 1.900 | x 0.350 =      | 1.663           |
|                                  |       | isolated footings   | 4   | x | 1.500  | x | 1.500 | x 0.350 =      | 3.150           |
|                                  |       | column  | 4   | x | 0.350  | x | 0.450 | x 1.650 =      | 1.040           |
|                                  |       |   |     |   |        |   |       | <b>5.852</b>   |                 |
| 56                               | 5.2.2 | Reinforced cement concrete work in walls (any thickness), including attached pilasters, buttresses, plinth and skirting courses, fillets, columns, pillars, piers, abutments, posts and struts etc. upto floor five level excluding cost of centring, shuttering, finishing and reinforcement--   |     |   |        |   |       |                |                 |
|                                  |       | 1:1½:3 ( 1 Cement: 1½ fine sand : 3 graded stone aggregate 20 mm nominal size)  |     |   |        |   |       |                |                 |
|                                  |       | column  | 4   | x | 0.350  | x | 0.450 | x 9.600        | 6.048           |
|                                  |       | lift Wall   | 1   | x | 8.800  | x | 0.20  | x 11.100       | 19.536          |
|                                  |       |   |     |   |        |   |       | <b>Total =</b> | <b>25.584</b>   |
| 57                               | 5.3.1 | Reinforced cement concrete work in beams, suspended floors, roofs having slope upto 15° landings, balconies, shelves, chajjas, lintels, bands, plain window sills, staircases and spiral stair cases upto floor five level excluding the cost of centring, shuttering, finishing and reinforcement--  |     |   |        |   |       |                |                 |
|                                  |       | 1:1½:3 ( 1 Cement: 1½ fine sand : 3 graded stone aggregate 20 mm nominal size)  |     |   |        |   |       |                |                 |
|                                  |       | RCC work in slab,   |     |   |        |   |       |                |                 |
|                                  |       | MACHINE ROOM SLAB   | 1   | x | 4.000  | x | 4.500 | x 0.150        | 2.700           |
|                                  |       | lift well roof at top   | 1   | x | 3.000  | x | 2.400 | x 0.130        | 0.936           |
|                                  |       | beam  | 2   | x | 8.500  | x | 0.300 | x 0.500        | 2.550           |
|                                  |       |   | 2   | x | 5.400  | x | 0.300 | x 0.400        | 1.296           |
|                                  |       |   |     |   |        |   |       | <b>35</b>      | <b>7.482</b>    |



36



37



38



39



11



[illegible]









SPECIFICATION SHOULD BE FOLLOWED  
AS PER BARRIERFREE ENVIRONMENT  
GUIDE LINES OF SUGAMYA BHARAT  
AVIJAN PROVIDED  
BY GOVT.OF INDIA

- \* ALL RAILING SHALL BE OF THE  
HEAVY WEIGHT GRADE. APPROX 12"
- \* THE FILL IN CORRIDOR WITH THE CORRIDOR  
DECK FOR THE FILL.
- \* THE FILL IS PERSONS.
- \* RAILING WITH CROSS OF GALV  
STEEL STRUCTURE.
- \* GALV PIPE OF SS PIPE IN CORRIDOR.  
CORRIDOR/STAIR CASE.
- \* SS PIPE RAILING IN THE BRIDGE OF  
STAIR.

PROPOSED REMODEL\  
REORIENTATION OF ROOMS  
of EXISTING BELONIA COURT  
BUILDING UNDER SUGAMYA  
BHARAT

AR. SANJIBAN DATTA  
SR.ARCHITECT



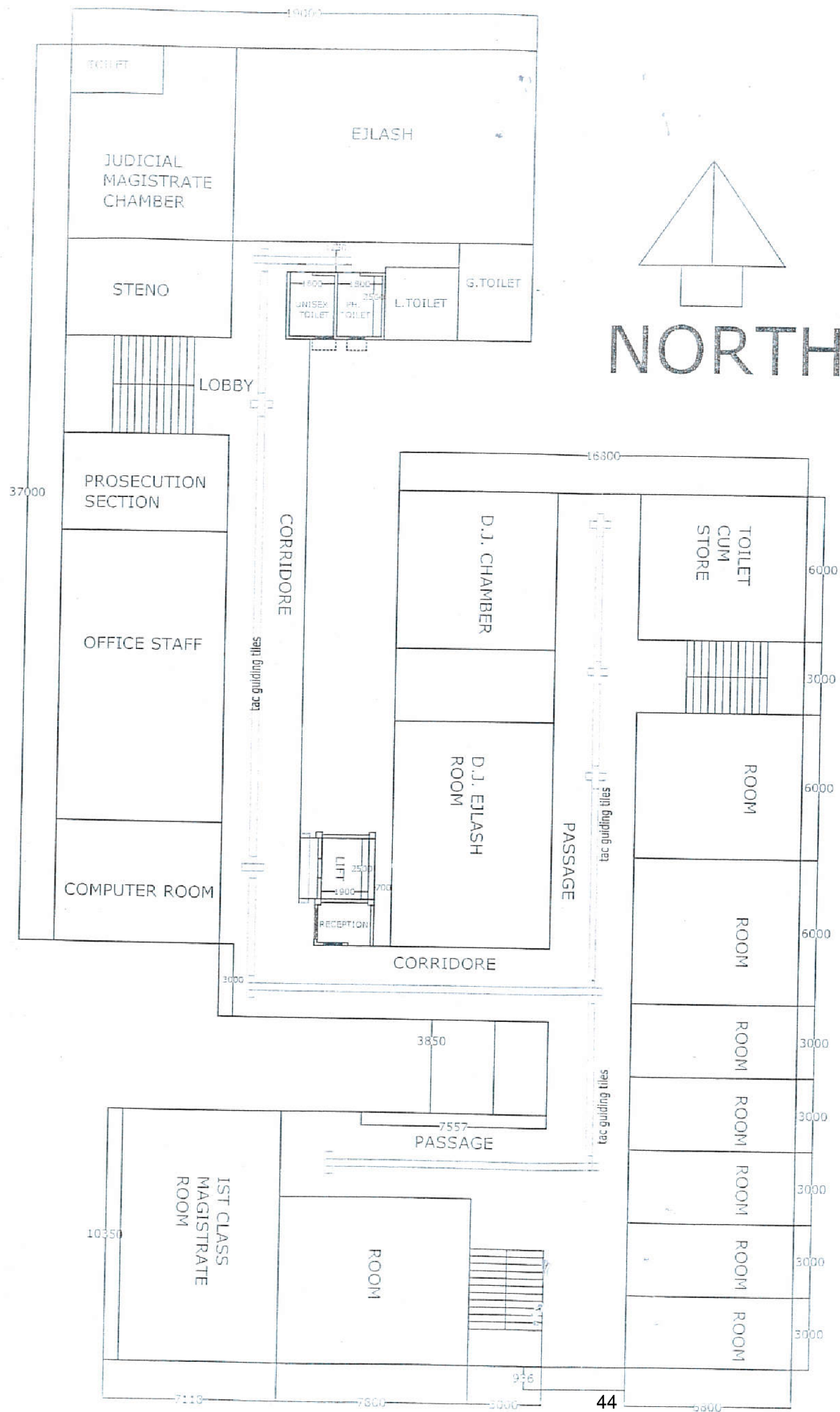

FIRST FLOOR

GOVT. OF TRIPURA.

SPECIFICATION SHOULD BE FOLLOWED  
AS PER BARRIERFREE ENVIRONMENT  
GUIDE LINES OF SUGAMYA BHARAT  
AVIJAN PROVIDED  
BY GOVT.OF INDIA

OFFICE OF THE SR ARCHITECT  
PWD

PROPOSED REMODEL/  
REORIENTATION OF ROOMS  
of EXISTING BELONIA COURT  
BUILDING UNDER SUGAMYA  
BHARAT

PRELIMINARY DRAWING

Date :- 28.08.2019

DRG. NO. 2-AR-9/961

sheet no- 2/2

AR. D. MAJUMDER

AR. AKAN DEBBARMA

AR. SANJIBAN DATTA